



TAPS

29th Tulsa Area Pony Show

Sponsored by
Oklahoma-Kansas Welsh Pony Society

May 28-30, 2016

Claremore Expo Center
400 Veterans Parkway
Claremore, Oklahoma

Recognized by the
Welsh Pony & Cob Society of America
Double Gold Sanctioning Applied For



Oklahoma-Kansas Welsh Pony Society
Tulsa Area Pony Show
May 28, 29, 30, 2016

Location	Claremore Expo Center
Recognized by	Welsh Pony and Cob Society of America <i>WPCSA Provisional Double Gold</i>
Judges	Karen Macleay (Show #1) Amanda Williams (Show #2)
Official Measurer	Connie Moore
Rules Commission <i>(All WPCSA rules apply)</i>	Daphne Dougherty, Ranae Smith Connie Moore
Course Designers	Driving Obstacle - Daphne Dougherty Hunter - Connie Moore Trail - Ranae Smith
Show Managers	Denise Dougherty, 580-402-6558 Ranae Smith, 918-798-2248
Farrier on Call	David Jackson, 918-396-1053
Veterinarian on Call	Andy Anderson, 918-252-7407
Secretary	Denise Dougherty, 580-402-6558
Stabling	Denise Dougherty, 580-402-6558

ENTRY CHECK LIST

- Entry form, both sides
- Proper fees ***made payable to: OKWPS***
- Copy of Registration papers of each pony/cob entered (front and back)
- Copy of measurement cards

Entry check list information is to be sent to:

Denise Dougherty 580-402-6558 (Denise cell)
2030 Lakeview Road 405-969-2073 (Denise home)
Crescent, OK 73028 denised0602@rocketmail.com

This show is conducted under the rules and regulations of the Welsh Pony & Cob Society of America, Inc. Points won will count toward WPCSA End of the Year Awards provided that owners, riders, and ponies are properly recorded and listed under their registered name and number.

Please send entries by May 15 to be included in the program.

Find us on Facebook @ OKWPS - Oklahoma Kansas Welsh Pony Society

Fees, Rules & Regs., Prize Monies 1

Fees: Entry Fee - Halter	\$25.00 for both judges
Entry Fee Performance	\$15.00 per class
Weekend Stall Fee	\$50.00 per stall
One Day Stall Fee	\$25.00 per stall
Measurement Fee	\$ 5.00 per head non-WPCSA member
WPCSA Recording Fee	\$ 5.00 per pony per judge (\$10 for weekend/pony)
Jump Fee	\$15.00 per pony
Office Fee	\$15.00 per owner

Post Entries: will be accepted at regular class fees.

Admission to Show: Free

Refunds: None

Returned Check Policy: If a check is returned unpaid, the show will assess a \$25.00 fee and a money order, cashiers check or cash must be presented to show management. No premiums will be paid until all delinquent funds are collected.

Office hours:

Noon to 7:00 pm - Friday.

7:00 am to close of show - Saturday, Sunday and Monday.

Show Check-in Requirements: All equine will be accompanied with a record of a negative official test for EIA (Coggins) conducted within the past 12 months. You must present the original form and not a copy upon arrival. Foals less than 6 months of age, accompanied by and nursing a negative tested mare are exempt from the testing requirements. This is a state law and show management will check papers when you arrive and if proper documentation is not present, you will not be permitted to remain on the grounds.

Measurements: All Welsh which do not possess a valid measurement card will be measured as required by the official measurer. Measurement will be Friday 7-9 pm. Alternate times will be posted. It is the owner's responsibility to make a measurement time. Animals five (5) and under shown only in halter are not subject to measurement.

Stalls and Bedding: Arrangements for access to stalls prior to 8:00 am Friday must make arrangements with Denise Dougherty (cell phone: 580-402-6558) to get into the stalls. **All bedding is in-house.** See Expo Center Rules on page 3.

Prize Monies: Total monies offered is \$1,245.00

Halter and Performance Champions (where indicated)	\$15 - \$10
All Breed Class Grand Champions and Supreme Gelding	\$25 - \$15
Supreme Champion.....	\$50 - \$25

Prize monies will be mailed within 60 days following the show.

Sanctioning: This is a Provisional Welsh Pony and Cob Society of America (WPCSA) Double Gold Show. All WPCSA classes will conform to the class specifications, which are included herein. Welsh performance championships are based on points only, no entry fees are required for those classes. To qualify for entry in Stake classes, the exhibitor must enter and compete in at least one other class in the division.

Classes: Show management reserves the right, with permission of the exhibitors, to cancel classes that have no entries, or to divide the classes in which the entries cannot be accommodated in the ring at one time, and to make such changes in the class schedule as dictated by the interest of the show. If there are 8 or more 12.2 and under and 8 or more over 12.2 to 14.2 hand ponies in any WPCSA class, it will be split. Classes are open to stallions, mares and geldings. WPCSA classes of less than three entries will receive reduced points and will not be combined.

2 Rules & Regulations

Breed Specifications: *Section A Welsh Pony* - Not exceeding 12.2 hands
 Section B Welsh Pony - Not exceeding 14.2 hands
 Section C Welsh Pony of Cob Type - 13.2 hands & under
 Section D Welsh Cob - Over 13.2 hands
 Small Pony - 12.2 hands and under
 Medium/Large Pony - Over 12.2 hands, not exceeding 14.2 hands

Attire: Riders must be properly attired according to the rules of the division in which they are competing. Riders in all classes where jumping is required, and when jumping elsewhere on the show grounds, must wear protective headgear. Numbers must be worn and be clearly visible.

Adult Exhibitors: An individual who has reached their 18th birthday as of December 1st of the current competition year.

Junior Exhibitors: An individual who has not reached their 18th birthday as of December 1st of the current competition year. When dividing junior divisions into two separate age groups, they will be split as follows: youth 12 & under and youth 13 and over (but have not reached their 18th birthday by December 1st of the current competition year. Juniors under 14 years of age cannot show a stallion. Junior Drivers under 14 years of age must have an experienced adult (over 18) in the carriage at all times. **Junior exhibitors must wear approved protective headgear (ASTM/SEI) at all times whenever mounted or in a driven vehicle at all times while on the show ground. Harness must be secured and properly fitted. Any rider violating this rule at any time must immediately be prohibited from further riding until such headgear is properly in place.**

Area Motels: Comfort Inn, 1750 S. Lynn Riggs Blvd. 918-343-3297 and Microtel, 918-343-2868. Due to two other large events in the area, we were unable to secure a block of rooms at a special rate.

Facilities: Claremore Expo Center has a 135'x265' Indoor Dirt Arena with bleacher seating, a 120'x210' Covered Arena with attached stall barn. Access to Indoor Arena is by covered walkway.

Concessions: Concessions on the show grounds are open from 7:30am to 6pm.

R.V. Hook-ups: The facility RV Park has full hook-ups and on-site dry camping on a nightly fee basis. It also boasts amenities such as BBQ grills, picnic tables, showers and laundry service, and a playground. Contact RV Park Manager for information (918) 342-5357 ext. 200.

Super Rec Center: Located across from the RV Park, the Super Rec Center has an Olympic size swimming pool, walking track, basketball courts, etc.

Expo Center Rules

Parking: Parking in front and side of the barns is restricted due to fire safety regulations and to allow exhibitors to pass from the stabling area to the show arena safely. Vehicles parked in restricted areas are subject to towing.

Bedding: Shavings are \$7.00 per bag (price subject to change based on the cost and availability of shavings.) One bag minimum is required with stall rental. ***Absolutely No Outside Bedding Allowed.***

Dog Policy: No dogs shall be allowed into the facility, except for those certified to assist the physically challenged. Only dogs on leashes shall be allowed in the exercise area or stall barn area.

Stalling: All animals entered or brought to events would ideally be stalled in the livestock facilities. No Jump-offs allowed. A minimum of one bag of bedding shall be required per stall. Barns and stalls are for the use of contracted facility events only.

No Taping, tacking stapling, nailing, gluing etc. on walls or other painted surfaces.

Smoking: The facility is a smoke-free facility. This includes the Exhibit Hall, Arena and Horse Barn. No smoking is allowed inside the buildings. Designated smoking sections are stationed outside the facilities.

Rules / Class Specifications 3

LIVESTOCK ANIMALS AND INHERENT RISK Persons engaged in livestock activities on the Claremore EXPO CENTER premises assume all risks associated with the inherent in the participation of such activities. The Claremore Cultural Development Authority and/or The city of Claremore shall not be responsible in any manner for injuries and/or damages, either seen or unforeseen, sustained by any person engaged in livestock activities on said premises as provided for under Oklahoma Law.

Class Specifications

WPCSA BREED CLASSES (Article 110.2) Animals are to be shown in hand at a walk and a trot except in group classes. Purebred Welsh to be judged 85% on breed type, conformation, way of going, quality and substance and 15% on disposition and manners. Natural reaching action is desired. Half-Welsh and Part Breds to be judged 85% on conformation, way of going, quality and substance and 15% on Welsh breed type, disposition and manners.

offered in both Shows

WPCSA WELSH ENGLISH PLEASURE (Article 112.3) To be shown at a walk, trot and canter both ways of the ring on light contact without a martingale. To be judged 75% on performance, manners, movement and style; 25 % on breed type and conformation. Working class to be judged 100% on performance.

offered in both Shows

WPCSA WELSH WESTERN PLEASURE (Article 112.4) To be shown at a walk, jog and lope both ways of the ring without a martingale, on a reasonably loose rein, without undue restraint. To be judged on performance, with emphasis on manners 65%; breed type, conformation and movement 25%; appointments 10%. Working classes are judged 100% on performance.

offered in Show #1 only

WPCSA WELSH HUNTER (Article 112.5) To be judged 75% on performance, manners, movement and style; 25% on breed type and conformation. Working classes judged 100% on performance. Animals not exceeding 13.2 hands will jump 2'.0"; animals exceeding 13.2 shall jump 2'6". Over fences (o/f): To be shown over a course of a minimum of **six** fences with eight jumping efforts of the required height. Under saddle (u/s): To be eligible, pony must have shown in and completed an over fence class. To be shown at the walk, trot and canter both ways of the ring. **May be required to hand gallop one way of the ring, but no more than eight animals at one time.**

offered in both Shows

WPCSA SHORT STIRRUP HUNTER (Article 112.6) Division is open to riders 12 years & under. Classes are open to all Ponies/Cobs/Half-Welsh/Part Bred, mares and geldings. **RIDERS** in this division, including the under saddle class, may not compete over fences in any other division except Short Stirrup Equitation. Courses to be set at 18" with a minimum of 4 fences with 8 jumping efforts required. May either trot or canter the course. Over-fence classes must precede the under-saddle class. To be judged 100% on performance. To be eligible for the under-saddle class, animal must have shown in **and completed** an over-fences class. Under-saddle class animals will be shown both ways of the ring at a walk, trot and canter. Not required to jog for over-fences classes.

offered in both Shows

WPCSA LOW HUNTER 18" or 2' (Article 112.8) Division is open to Ponies/Cobs and Half-Welsh/Part Breds, Juniors and Adults. These **ANIMALS** may not compete in any other over fences division at that show where fence heights exceed 18". There are no restrictions on the rider unless they are restricted by other class rules. Long Stirrup riders are eligible if jumping 18" but Short Stirrup riders are not eligible to compete. Courses to be set at 18" or 2' with a minimum of 4 fences with 8 jumping efforts required. Jumps must be verticals (no cross rails). Riders may choose to jump 18" or 2'. Fence heights are not determined by the height of the animal. No animal may jump both 18" and 2" in this division at the same show. Over-fences classes must precede the under-saddle classes. To be judged 100% on performance. May either trot or canter the course. Not required to jog for over-fences classes.

offered in both Shows

WPCSA HUNTER SEAT EQUITATION (Article 114.3) Classes open to Ponies/Cobs/Half-Welsh/Part Breds. To be judged on the rider's appearance, seat, hands and control and of their mount. Animals 13.2 and under jump 2'; animals over 13.2 jump 2'6". Over-fences (o/f) classes: to be shown over a minimum of six obstacles. Under-saddle (u/s) classes: To be shown at walk, trot and canter both ways of the ring. Tests may be required.

offered in both Shows

4 Class Specifications

Removing the bridle from an animal harnessed to a vehicle, or leaving an animal unattended while hitched, anywhere on the show grounds, will result in instant elimination and removal from the show grounds.

WPCSA PLEASURE DRIVING (Article 113.1) To be shown to a suitable two or four-wheeled vehicle or four-wheeled vehicle for pairs, but not a viceroi, racing sulky or fine harness rig. Use of a bike style vehicle with floorboards and a basket is acceptable. To be shown both ways of the ring at a walk, working trot and trot on and stand quietly and except for tandems, **to back readily**. A properly attired groom or passenger *capable of rendering assistance in case of emergency* is required for all pairs and tandems; unicorns and four-in-hands require 2 grooms/passengers. Failure to comply will result in elimination from the class. To be judged 75% on performance, manners, movement and style; 25% on breed type and conformation. Working classes are judged 100% on performance.

offered in both Shows

WPCSA CARRIAGE DRIVING (Article 113.2) (wire-wheeled vehicles may be used at this show) Classes open to Ponies/Cobs/Half-Welsh/Part Breds. To be shown both ways of the ring at a walk, slow trot, working trot and strong trot. To stand quietly, both on the rail and while lined up, and to rein back. In the slow trot the animal should maintain forward impulsion while showing submission to the bit. A properly attired groom or passenger *capable of rendering assistance in case of an emergency* is required for all pairs and tandems; unicorns and four-in-hands require 2 grooms/passengers. Failure to comply will result in elimination from the class.

offered in both Shows

WPCSA CARRIAGE DRIVING TURNOUT (Article 113.2.3) To be judged primarily on the performance and quality of each turnout. To be shown both ways of the ring at a walk, slow trot, working trot and strong trot. To stand quietly and to rein back. To be judged 70% on the condition, fit and appropriateness of harness and vehicle, neatness and appropriateness of attire and overall impression: 30% on performance, manners and way of going.

WPCSA CARRIAGE DRIVING WORKING (Article 113.2.3) To be judged primarily on the suitability of the animal to provide a pleasant drive. To be shown both ways of the ring at a walk, slow trot, working trot and strong trot. To stand quietly, both on the rail and while lined up, and to rein back. May be asked to execute appropriate tests. To be judged 70% on performance, manners and way of going; 20% on the condition and fit of harness and vehicle; 10% on neatness of attire.

WPCSA OBSTACLE/CONES DRIVING (Article 113.2.3) Obstacle/Cones to be judged 100% on performance. Course plan must be announced and posted one hour before competition is to begin. Competitors may walk the course. Martingales and overchecks are prohibited in obstacle classes for all vehicles. Side checks are optional. Failure to comply incurs elimination. Refer to specifications in rule book (Article 113.2.3) for the type of obstacle/cones classes being offered.

WPCSA Obstacle - Time Competition

Not to exceed 20 obstacles (pairs of cones topped with tennis balls). Faults add seconds to total time. Fastest time wins.

1. To be driven over a prescribed course of obstacles. The number of obstacles to be proportionate to the dimensions of the driving area. Not to exceed 20 obstacles.
2. After passing the starting line, the driver shall proceed through each obstacle in order to the designated finish line.
3. Course faults are scored as penalty seconds and are added to the driver's elapsed time. Placings are determined on a low total time basis. Ties for first will be decided by a drive-off (unless otherwise stated in the prize list).
4. Penalties:
 - a) Exceeding time allowed (every commenced second) 0.5 second
 - b) Knocking over start or finish marker 5 seconds
 - c) Knocking down or dislodging obstacle 5 seconds
 - d) Break in gait, if not allowed
 - 1st break from trot 5 seconds
 - 2nd break from trot 5 seconds
 - 3rd break from trot 5 seconds
 - 4th break from trot Elimination
 - Prolonged canter or walk Elimination
 - e) Disobedience and/or groom dismounting (cumulative over course)
 - 1st incident 5 seconds
 - 2nd incident 10 seconds
 - 3rd incident Elimination
 - f) Starting before signal Elimination

Class Specifications 5

- g) Failure to cross starting line within one minute of signal Elimination
- h) Off course Elimination
- i) Exceeding time limit (2X time allowed) Elimination
- j) Outside assistance Elimination
- k) Failure to carry whip Elimination
- l) Use of a tie-down or overcheck Elimination
- m) Breakage of harness or vehicle Elimination

Article 115.4.1 LEADLINE CLASS SPECIFICATIONS In all Leadline classes the leadline is to be attached to the cavesson on the English bridle and on the Western bridle to the cheek slot of the bit (top of the bit). No chain leadlines allowed.

offered in Show #1 only

WPCSA LEADING REIN (Article 115.1) Section A, B, C or Half-Welsh/Part Breds, mare or gelding, 12.2 hands and under, to be ridden by junior exhibitors at least four, but not more than eight, years of age. To be shown on light contact and led by an adult. See rules for attachment of leading rein. No chain leadlines allowed. To be shown at a walk, on the right rein (clockwise), to line up and stand quietly Ponies to be called out individually to stand, walk out, and trot or jog back past the judge. **Ponies to be judged** on manners, suitability, breed type, conformation and turn-out. This is not an equitation class. **There are no restrictions for the pony or rider.**

offered in Show #1 only

WPCSA CHILD'S FIRST PONY (Article 115.2) Section A, B, C, Half-Welsh or Part Bred, mare or gelding 12.2 hands and under, to be ridden by junior exhibitors at least four, but no more than 10, years of age. Riders to be suitably dressed in Hunt, Saddle or Western attire including protective headgear. Ponies to be shown at a walk and trot or jog, both ways of the ring. **Ponies to be judged** on performance, manners and suitability. Conformation, way of going, manners, suitability and turnout to be emphasized. This is not an equitation class. **There are no restrictions for the pony or rider.**

offered in Show #1 only

WPCSA TRAIL (Article 115.3) Open to all Ponies/Cobs/Half-Welsh/Part Breds. Junior and adult (separate divisions are to be offered for juniors and adults). English or Western equipment. To be shown over and through obstacles at a walk, optional trot or jog and optional canter or lope. To be judged 100% on performance.

offered in Show #2 only

WPCSA LEADLINE WALK (Article 115.4) Classes open to riders 7 & under mounted on Ponies/Cobs/Half-Welsh/Part Breds, mares and geldings. See rules for attachment of leading rein. No chain leadlines allowed. Judged on equitation and suitability of mount at a walk. To stand quietly. To be led by an adult or a junior age 12 or over. Both handler and rider to be appropriately attired. English or Western attire is acceptable. **RIDERS** ineligible for other ridden classes except costume, leading rein, leadline walk-trot, and leadline walk-trot poles.

offered in Show #1 only

WPCSA LEADLINE WALK-TROT (Article 115.4) Classes open to riders 7 & under mounted on Ponies/Cobs/Half-Welsh/Part Breds, mares and geldings. See rules for attachment of leading rein. No chain leadlines allowed. Judged on equitation and suitability of mount at a walk and trot/jog. To stand quietly. To be led by an adult or a junior age 12 or over. Both handler and rider to be appropriately attired. English or Western attire is acceptable. **RIDERS** ineligible for other ridden classes except costume, leading rein, leadline walk and leadline walk-trot poles.

offered in Show #1 only

WPCSA WALK (Article 115.5) Classes open to riders 11 & under mounted on Ponies/Cobs/Half-Welsh/Part Breds, mares and geldings. Judged on equitation and suitability of mount. English or Western attire is acceptable. **RIDERS** ineligible for other ridden classes except costume, leading rein, child's first pony, walk-trot and walk-trot poles. To walk both ways of the ring.

offered in Show #1 only

WPCSA WALK-TROT (Article 115.5) Classes open to riders 11 & under mounted on Ponies/Cobs/Half-Welsh/Part Breds, mares and geldings. Judged on equitation and suitability of mount. To walk and trot/jog both ways of the ring. Possible test to include: walk, trot/jog, turn, halt and rein back at spots marked. English or Western attire is acceptable. **RIDERS** ineligible for other ridden classes except costume, leading rein, child's first pony, walk and walk-trot poles.

offered in Show #1 only

WPCSA WALK-TROT POLES (Article 115.5) Classes open to riders 11 & under mounted on Ponies/Cobs/Half-Welsh/Part Breds, mares and geldings. Judged on equitation and suitability of mount. To be ridden once around a course of four poles on the ground entirely at a walk or entirely at a trot/jog. Poles are to be placed at a minimum of

6 Class Specifications

4 feet off the rail, two on each side of the ring, simulating a hunter course. The poles should be placed far enough away from the entrance gate to provide an adequate sized area to do an opening and closing circle. English or Western attire is acceptable. **RIDERS** ineligible for other ridden classes except costume, leading rein, child's first pony, walk and walk-trot.

offered in Show #1 only

WPCSA JUNIOR WELSH HANDLER (Article 115.6) Class open to juniors handling Ponies/Cobs/Half-Welsh/Part Breds mares and geldings. Judged on the ability and skill of the Junior in handling their animal as in the breed ring. The show qualities of the animal shall not be considered, although cleanliness and grooming can be considered. Exhibitors enter to the left so as not to obscure the judge's view. The judge evaluates the ability of the junior to follow directions, use space wisely, and execute the requested patterns. Juniors should appear "ring wise", be alert to the judging progression and be prepared for changes in the judging routine.

offered in Show #2 only

WPCSA RIDDEN WELSH CLASSIC SEC. C & D (Article 115.7) This class is for registered Welsh Cobs and Welsh Ponies of Cob Type 4 years of age and over. To be judged 50% on conformation and 50% on performance. Entries shall enter the arena in a clockwise direction. To be shown on both reins as a group at the walk, trot, and canter with animation. The required individual performance must show all four gaits (the gallop need only be shown in one direction). Each animal will then be stripped and judged for conformation judging, showing at the walk and trot, in hand, by the rider. Once an entry has been judged for conformation it may be retacked. Class is an English class only. No Western, Saddle Seat or Side Saddle tack or attire. Qualified UK or American Judge to officiate.

offered in Show #2 only

WPCSA RIDDEN WELSH CLASSIC SEC. A & B (Article 115.7) This class is for registered Welsh Ponies, Section A & B, 4 years of age and over. To be judged 50% on conformation and 50% on performance. Entries shall enter the arena in a clockwise direction. To be shown on both reins as a group at the walk, trot, and canter with animation. The required individual performance must show all four gaits (the gallop need only be shown in one direction). Each animal will then be stripped and judged for conformation judging, showing at the walk and trot, in hand, by the rider. Once an entry has been judged for conformation it may be retacked. Class is an English class only. No Western, Saddle Seat or Side Saddle tack or attire. Qualified UK or American Judge to officiate.

offered in Show #2 only

WPCSA RIDDEN WELSH CLASSIC CHAMPIONSHIP CLASS (Article 115.7) To be judged 50% on conformation and 50% on ridden performance. Open to first and second place winners from Ridden Welsh A/B Classic and the Ridden Welsh C/D Classic. There is no entry fee for this class. Places will be awarded for the Best Ridden and the Reserve Best Ridden. Any animal in this class is eligible to be named the Best Ridden. Entries shall enter the arena in a clockwise direction. The Judge shall request all four gaits (walk, trot, canter, gallop) in at least one direction, but animals need not show in both directions. The judge shall consider the size of the ponies/cobs, ages of riders, safety of arena when determining whether to have the animals perform as a group or individually. Individual pattern is optional at the judge's discretion. Entries shall not be stripped as conformation score from the qualifying class shall be carried forward.

offered in Show #2 only

WPCSA WALK-TROT ADULT EQUITATION (Article 115.8) Class open to riders 18 years of age and older on ponies, cobs, Half-Welsh or Part Breds. English or Western attire is acceptable. Riders ineligible for any other WPCSA pointed ridden class at that show. Judged on equitation and suitability of mount. To walk and trot or jog both ways of the ring. Possible tests to include: walk, trot or jog, turn, halt and rein back at spots marked.

offered in Show #1 only

NON-POINTED CLASSES

WALK-TROT TRAIL (Article 116.6) Open to riders 11 & under mounted on Ponies/Cobs/Half-Welsh/Part Breds, mares and geldings. To be shown over and through obstacles at a walk, optional trot or jog and optional canter or lope. To be judged 100% on performance. Pattern will not include a side pass or loping/cantering over loose rails.

offered in Show #2 only

PET PONY OBSTACLE Safety is a primary concern and suitability of child to pony will be emphasized. Child will lead pony over and around obstacles demonstrating their ability to control and maneuver the pony in a safe manner. Attire is not to be considered in judging unless considered unsafe. Adults or older juniors may accompany child and pony in the ring.

offered in Show #1 only

Class Specs / Saturday Performance 7

OBSTACLE/CONES UNDER SADDLE - TIMED COMPETITION Open to any age rider on ponies, cobs, Half-Welsh or Part Breds. English or Western tack is acceptable. Rider attire not a factor but all safety rules for the show will be enforced. Course will consist of ten sets of numbered cones. Exhibitors will trot the course in order 1-10 then, without passing through start/finish, lope or canter the course 1-10. Time starts and ends at start/finish cones. Faults will add to overall time. All applicable Obstacle/Cones Driving penalties will apply. To be judged 100% on performance.

offered in Show #1 only

OBSTACLE/CONES UNDER SADDLE - REVERSE PSYCHOLOGY Open to any age rider on ponies, cobs, Half-Welsh or Part Breds. English or Western tack is acceptable. Rider attire not a factor but all safety rules for the show will be enforced. Course will consist of ten sets of numbered cones. After passing through the Start markers, all the obstacles shall be driven in the correct sequence. After completing the highest-numbered obstacle, the rider will then turn and ride that obstacle in the reverse direction and continue to ride all the remaining obstacles in reverse order and in the reverse direction and through the Finish markers where timing will stop. Course may ridden at the trot or lope/canter. Faults will add to overall time. All applicable Obstacle/Cones Driving penalties will apply. To be judged 100% on performance.

offered in Show #2 only

DRIVE AND RIDE Open to ponies, cobs, Half-Welsh or Part Breds. The entry may be shown by the same person in both sections or one in the drive section and another in the ride section. Up to two grooms or attendants may assist with unharnessing and saddling. The judge may not request entries to be re-harnessed after performing under saddle. The judge may allow vehicles to remain in the arena or request that they be removed. If vehicles are removed, additional attendants may enter the arena to assist. Single animal to be shown in two concurrent sections. In Harness: To be shown to a suitable pleasure driving vehicle, both ways of the arena at a walk, slow trot, working trot, and strong trot. To stand quietly and to rein back. Under Saddle: To be shown both ways of the arena at a walk, trot (or jog), and canter (or lope). To stand quietly and to rein back. To be judged 50% on performance, manners, way of going and suitability in harness, 50% on performance, manners, and way of going under saddle.

offered in Show #2 only

Show #1 - Saturday, May 28, 2016 8:00 am Judge: Karen Macleay

Inside Arena hunter course available for warm-up and schooling

Outdoor Covered Arena

- 1 WPCSA Leadline Walk, Child 7 and under
- 2 WPCSA Leadline Walk-Trot, Child 7 and under
- 3 WPCSA Leading Rein, Child 4-8
- 4 WPCSA Child's First Pony, 12.2 & under, Child 4-10
- 5 WPCSA Walk, Child 11 and under
- 6 WPCSA Walk-Trot, Child 11 and under
- 7 WPCSA Walk-Trot Poles, Child 11 & under
- 8 Pet Pony Obstacle, Child 11 and under (class will be split if entries warrant)

Outdoor Covered Arena will have schooling jumps set up

Inside Arena

- 9 WPCSA Working Hunter Over Fences, C/D, Junior/Adult
- 10 WPCSA Conformation Hunter Stake Over Fences, C/D, Junior/Adult
- 11 WPCSA Conformation Hunter Under Saddle, C/D, Junior/Adult
- 12 Champion C/D Hunter, Junior/Adult\$15
- 12R Reserve Champion C/D Hunter, Junior/Adult\$10

8 Saturday Performance

13	WPCSA Working Hunter Over Fences, Half-Welsh/Part Bred, Junior/Adult	
14	WPCSA Conformation Hunter Stake Over Fences, Half-Welsh/Part Bred, Junior/Adult	
15	WPCSA Conformation Hunter Under Saddle, Half-Welsh/Part Bred, Junior/Adult	
16	Champion Half-Welsh/Part Bred Hunter, Junior/Adult\$15
16R	Reserve Champion Half-Welsh/Part Bred Hunter, Junior/Adult\$10
17	WPCSA Working Hunter Over Fences, A/B, Junior	
18	WPCSA Conformation Hunter Stake Over Fences, A/B, Junior	
19	WPCSA Conformation Hunter Under Saddle, A/B, Junior	
20	Champion A/B Hunter, Junior\$15
20R	Reserve Champion A/B Hunter, Junior\$10
21	WPCSA Working Hunter Over Fences, A/B, Adult	
22	WPCSA Conformation Hunter Stake Over Fences, A/B, Adult	
23	WPCSA Conformation Hunter Under Saddle, A/B, Adult	
24	Champion A/B Hunter, Adult\$15
24R	Reserve Champion A/B Hunter, Adult\$10
25	WPCSA Low Working Hunter Over Fences 18" or 2', Junior/Adult	
26	WPCSA Low Working Hunter Stake Over Fences 18" or 2', Junior/Adult	
27	WPCSA Low Working Hunter Under Saddle, Junior/Adult	
28	Champion Low Hunter Junior/Adult\$15
28R	Reserve Champion Low Hunter Junior/Adult\$10
29	WPCSA Short Stirrup Working Hunter Over Fences 12 & under	
30	WPCSA Short Stirrup Working Hunter Stake Over Fences 12 & under	
31	WPCSA Short Stirrup Working Under Saddle 12 & under	
32	Champion Short Stirrup Hunter 12 & under\$15
32R	Reserve Champion Short Stirrup Hunter 12 & under\$10

Outdoor Covered Arena will be available for warm-up

Inside Arena (after jumps are removed)

33	WPCSA Hunter Seat Equitation On the Flat A/B/C/D/H/PB Junior	
34	WPCSA Conformation English Pleasure, C/D, Adult	
35	WPCSA English Pleasure Working, C/D, Adult	
36	WPCSA Conformation English Pleasure, A/B, Adult	
37	WPCSA English Pleasure Working, A/B, Adult	
38	WPCSA Conformation English Pleasure, Half-Welsh/Part Bred, Junior/Adult	
39	WPCSA English Pleasure Working, Half-Welsh/Part Bred, Junior/Adult	
40	WPCSA Conformation English Pleasure, C/D, Junior	
41	WPCSA English Pleasure Working, C/D, Junior	
42	WPCSA Conformation English Pleasure, A/B, Junior	
43	WPCSA English Pleasure Working, A/B, Junior	

Saturday Performance 9

44	WPCSA Conformation English Pleasure Stake, C/D, Adult	
45	Champion English Pleasure, C/D, Adult\$15
45R	Reserve Champion English Pleasure, C/D, Adult\$10
46	WPCSA Conformation English Pleasure Stake, A/B, Adult	
47	Champion English Pleasure, A/B, Adult\$15
47R	Reserve Champion English Pleasure, A/B, Adult\$10
48	WPCSA Conformation English Pleasure Stake, Half-Welsh/Part Bred, Junior/Adult	
49	Champion English Pleasure, Half-Welsh/Part Bred, Junior/Adult\$15
49R	Reserve Champion English Pleasure, Half-Welsh/Part Bred, Junior/Adult\$10
50	WPCSA Conformation English Pleasure Stake, C/D, Junior	
51	Champion English Pleasure, C/D, Junior\$15
51R	Reserve Champion English Pleasure, C/D, Junior\$10
52	WPCSA Conformation English Pleasure Stake, A/B, Junior	
53	Champion English Pleasure, A/B, Junior\$15
53R	Reserve Champion English Pleasure, A/B, Junior\$10

Inside Arena will be available for driving warm-up

Outdoor Covered Arena

54	WPCSA Walk-Trot Adult Equitation	
55	WPCSA Conformation Western Pleasure, Half-Welsh/Part Bred, Junior/Adult	
56	WPCSA Western Pleasure Working, Half-Welsh/Part Bred, Junior/Adult	
57	WPCSA Conformation Western Pleasure, A/B, Adult	
58	WPCSA Western Pleasure Working, A/B, Adult	
59	WPCSA Conformation Western Pleasure, C/D, Junior/Adult	
60	WPCSA Working Western Pleasure, C/D, Junior/Adult	
61	WPCSA Conformation Western Pleasure, A/B, Junior	
62	WPCSA Western Pleasure Working, A/B, Junior	
63	WPCSA Conformation Western Pleasure Stake, Half-Welsh/Part Bred, Junior/Adult	
64	Champion Western Pleasure, Half-Welsh/Part Bred, Junior/Adult\$15
64R	Reserve Champion Western Pleasure, Half-Welsh/Part Bred, Junior/Adult\$10
65	WPCSA Conformation Western Pleasure Stake, A/B, Adult	
66	Champion Western Pleasure, A/B Adult\$15
66R	Reserve Champion Western Pleasure, A/B Adult\$10
67	WPCSA Conformation Western Pleasure Stake, C/D, Junior/Adult	
68	Champion Western Pleasure, C/D Junior/Adult\$15
68R	Reserve Champion Western Pleasure, C/D Junior/Adult\$10

10 Sat. Performance / Sunday Halter

69	WPCSA Conformation Western Pleasure Stake, A/B, Junior	
70	Champion Western Pleasure, A/B Junior\$15
70R	Reserve Champion Western Pleasure, A/B Junior\$10

Outdoor Covered Arena will be available for driving warm-up and holding area

Inside Arena

71	WPCSA Carriage Driving Turnout, A/B/C/D/H/PB	
72	WPCSA Carriage Driving Working, A/B/C/D/H/PB	
73	WPCSA Conformation Pleasure Driving, Sec. C & D	
74	WPCSA Conformation Pleasure Driving, Sec. A & B 14.2 & under	
75	WPCSA Pleasure Driving Working, Sec. C & D	
76	WPCSA Pleasure Driving Working, Sec. A & B 14.2 & under	
77	WPCSA Conformation Pleasure Driving Stake, Sec. C & D	
78	WPCSA Conformation Pleasure Driving Stake, Sec. A & B 14.2 & under	
79	Champion Pleasure Driving C & D\$15
79R	Reserve Champion Pleasure Driving C & D\$10
80	Champion Pleasure Driving A & B\$15
80R	Reserve Champion Pleasure Driving A & B\$10
81	WPCSA Obstacle/Cones - Time Competition, A/B/C/D/H/PB	
82	Champion Carriage Driving A/B/C/D/H/PB\$15
82R	Reserve Champion Carriage Driving A/B/C/D/H/PB\$10
83	Obstacle/Cones Under Saddle - Time Competition - Open	

Breeding Classes - Sunday, May 29, 2016 9:00 a.m.

Show #1 Judge: Karen Macleay and Show #2 Judge: Amanda Williams

Inside Arena available for warm-up and schooling

Outdoor Covered Arena

Half-Welsh/Part Bred

101 & 201	WPCSA Half-Welsh/Part Bred, 2 & under
102 & 202	WPCSA Half-Welsh/Part Bred, Mares 3 & over	
103 & 203	WPCSA Half-Welsh/Part Bred, Geldings & Stallions 3 & over	
104 & 204	WPCSA Senior Champion Half-Welsh/Part Bred	
104R & 204R	WPCSA Senior Reserve Champion Half-Welsh/Part Bred	
105 & 205	WPCSA Grand-Champion Half-Welsh/Part Bred\$25
105R & 205R	WPCSA Reserve Grand-Champion Half-Welsh/Part Bred\$15

Geldings

106 & 206	WPCSA Section B Gelding, any age
107 & 207	WPCSA Section A Gelding, any age
108 & 208	WPCSA Section C & D Gelding, any age

Sunday Halter & Performance 11

109 & 209	WPCSA Supreme Champion Gelding	\$25
109R & 209R	WPCSA Reserve Supreme Champion Gelding	\$15
Fillies		
110 & 210	WPCSA Section B Fillies, 2 & under	
111 & 211	WPCSA Section A Fillies, 2 & under	
112 & 212	WPCSA Section C & D Fillies, 2 & under	
Mares		
113 & 213	WPCSA Section B Mares, 3 & over	
114 & 214	WPCSA Section A Mares, 3 & over	
115 & 215	WPCSA Section C & D Mares 3 & over	
Colts		
116 & 216	WPCSA Section B Colts, 2 & under	
117 & 217	WPCSA Section A Colts, 2 & under	
118 & 218	WPCSA Section C & D Colts, 2 & under	
Stallions		
119 & 219	WPCSA Section B Stallions, 3 & over	
120 & 220	WPCSA Section A Stallions 3 & over	
121 & 221	WPCSA Section C & D Stallions 3 & over	
122 & 222	WPCSA Grand Champion Section B	\$25 - \$25
122R & 222R	WPCSA Reserve Grand Champion Section B	\$15 - \$15
123 & 223	WPCSA Grand Champion Section A	\$25 - \$25
123R & 223R	WPCSA Reserve Grand Champion Section A	\$15 - \$15
124 & 224	WPCSA Grand Champion Section C & D	\$25 - \$25
124R & 224R	WPCSA Reserve Grand Champion Section C & D	\$15 - \$15
125 & 225	WPCSA Supreme Champion	\$50 - \$50
125R & 225R	WPCSA Reserve Supreme Champion	\$25 - \$25

Classes for all sections will be split if numbers warrant

- 226 WPCSA Junior Welsh Handler, Child 13-17
- 227 WPCSA Junior Welsh Handler, Child 12 and under

Show #2 Sunday, May 29, 2016 Judge: Amanda Williams

Classes to start no sooner than 1 hour after Junior Handler classes

Outdoor Covered Arena available for warm-up and schooling until Trail is set-up

Inside Arena

- 228 WPCSA Ridden Welsh Classic A/B
- 229 WPCSA Ridden Welsh Classic C/D
- 230 WPCSA Ridden Welsh Classic Championship
- 231 WPCSA Carriage Driving Turnout A/B/C/D/H/PB
- 232 WPCSA Carriage Driving Working A/B/C/D/H/PB
- 233 WPCSA Conformation Pleasure Driving, Sec. C & D
- 234 WPCSA Conformation Pleasure Driving, Sec. A & B 14.2 & under

12 Sunday & Monday Performance

235	WPCSA Pleasure Driving Working , Sec. C & D	
236	WPCSA Pleasure Driving Working , Sec. A & B 14.2 & under	
237	WPCSA Conformation Pleasure Driving Stake, Sec. C & D	
238	WPCSA Conformation Pleasure Driving Stake, Sec. A & B 14.2 & under	
239	Champion Pleasure Driving C & D\$15
239R	Reserve Champion Pleasure Driving C & D\$10
240	Champion Pleasure Driving A & B\$15
240R	Reserve Champion Pleasure Driving A & B\$10
241	WPCSA Obstacle/Cones - Time Competition, A/B/C/D/H/PB	
242	Champion Carriage Driving A/B/C/D/H/PB\$15
242R	Reserve Champion Carriage Driving A/B/C/D/H/PB\$10
243	Obstacle/Cones Under Saddle - Reverse Psychology - Open	
244	Drive and Ride - Open	

Outdoor Covered Arena

245	WPCSA Trail, A/B/C/D/H/PB, Adult
246	WPCSA Trail, A/B/C/D/H/PB, Junior
247	Walk-Trot Trail 11 & under

Show #2 Monday, May 30, 2016 Judge: Amanda Williams

8:00 a.m. MEMORIAL DAY TRIBUTE (show will start following presentation)

Outdoor Covered Arena will have schooling jumps set up

Inside Arena

248	WPCSA Working Hunter Over Fences, C/D, Junior/Adult	
249	WPCSA Conformation Hunter Stake Over Fences, C/D, Junior/Adult	
250	WPCSA Conformation Hunter Under Saddle, C/D, Junior/Adult	
251	Champion C/D Hunter, Junior/Adult\$15
251R	Reserve Champion C/D Hunter, Junior/Adult\$10
252	WPCSA Working Hunter Over Fences, Half-Welsh/Part Bred, Junior/Adult	
253	WPCSA Conformation Hunter Stake Over Fences, Half-Welsh/Part Bred, Junior/Adult	
254	WPCSA Conformation Hunter Under Saddle, Half-Welsh/Part Bred, Junior/Adult	
255	Champion Half-Welsh/Part Bred Hunter, Junior/Adult\$15
255R	Reserve Champion Half-Welsh/Part Bred Hunter, Junior/Adult\$10
256	WPCSA Working Hunter Over Fences, A/B, Junior	
257	WPCSA Conformation Hunter Stake Over Fences, A/B, Junior	
258	WPCSA Conformation Hunter Under Saddle, A/B, Junior	
259	Champion A/B Hunter, Junior\$15
259R	Reserve Champion A/B Hunter, Junior\$10

Monday Performance 13

260	WPCSA Working Hunter Over Fences, A/B, Adult	
261	WPCSA Conformation Hunter Stake Over Fences, A/B, Adult	
262	WPCSA Conformation Hunter Under Saddle, A/B, Adult	
263	Champion A/B Hunter, Adult	\$15
263R	Reserve Champion A/B Hunter, Adult	\$10
264	WPCSA Low Working Hunter Over Fences 18" or 2', Junior/Adult	
265	WPCSA Low Working Hunter Stake Over Fences 18" or 2', Junior/Adult	
266	WPCSA Low Working Hunter Under Saddle, Junior/Adult	
267	Champion Low Hunter	\$15
267R	Reserve Champion Low Hunter	\$10
268	WPCSA Short Stirrup Working Hunter Over Fences 12 & under	
269	WPCSA Short Stirrup Working Hunter Stake O/F 12 & under	
270	WPCSA Short Stirrup Working Under Saddle 12 & under	
271	Champion Short Stirrup Hunter	\$15
271R	Reserve Champion Short Stirrup Hunter	\$10

Outdoor Covered Arena will be available for warm-up and schooling

Inside Arena

272	WPCSA Hunter Seat Equitation On the Flat A/B/C/D/H/PB Junior	
273	WPCSA Conformation English Pleasure, C/D, Junior/Adult	
274	WPCSA English Pleasure Working, C/D, Junior/Adult	
275	WPCSA Conformation English Pleasure, A/B, Adult	
276	WPCSA English Pleasure Working, A/B, Adult	
277	WPCSA Conformation English Pleasure, Half-Welsh/Part Bred, Junior/Adult	
278	WPCSA English Pleasure Working, Half-Welsh/Part Bred, Junior/Adult	
279	WPCSA Conformation English Pleasure, A/B, Junior	
280	WPCSA English Pleasure Working, A/B, Junior	
281	WPCSA Conformation English Pleasure Stake, C/D, Junior/Adult	
282	Champion English Pleasure, C/D, Junior/Adult	\$15
282R	Reserve Champion English Pleasure, C/D, Junior/Adult	\$10
283	WPCSA Conformation English Pleasure Stake, A/B, Adult	
284	Champion English Pleasure, A/B, Adult	\$15
284R	Reserve Champion English Pleasure, A/B, Adult	\$10
285	WPCSA Conformation English Pleasure Stake, Half-Welsh/Part Bred, Junior/Adult	
286	Champion English Pleasure, Half-Welsh/Part Bred, Junior/Adult	\$15
286R	Reserve Champion English Pleasure, Half-Welsh/Part Bred, Junior/Adult	\$10
287	WPCSA Conformation English Pleasure Stake, A/B, Junior	
288	Champion English Pleasure, A/B, Junior	\$15
288R	Reserve Champion English Pleasure, A/B, Junior	\$10

14 Show Layout



Claremore is located NE of Tulsa on historic Route 66. The Expo Center is located in the heart of the city on State Highway 20 and Will Rogers Boulevard. The facility officially opened in December of 1999.

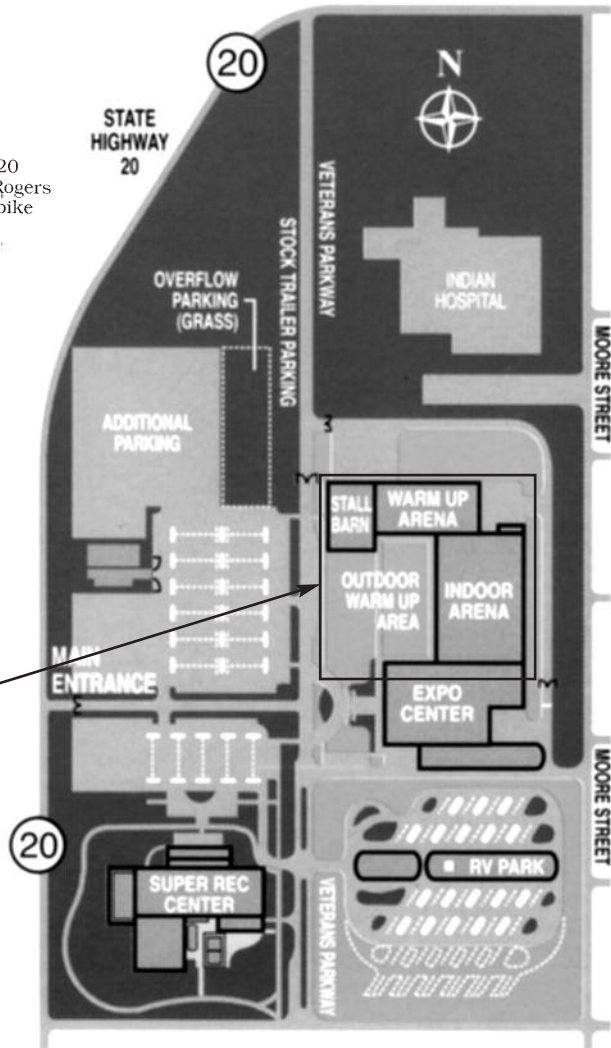
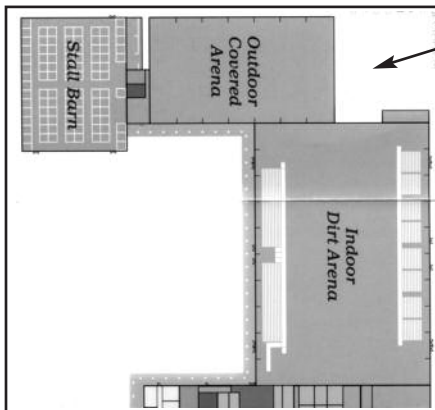

Under the Oklahoma law, an equine activity sponsor or equine professional is not liable for any injury of a participant in equine activities resulting from the inherent risks of equine activities pursuant to the Oklahoma Livestock Activities Liabilities Limitations Act.

WELSH PONY & COB SOCIETY OF AMERICA, INC. MEMBERSHIP APPLICATION

Applicant(s) Name _____

Address _____

City/State/Zip _____ Telephone _____

Email _____ Website _____

*NOTE: All Annual Memberships expire on December 31 of the current year, regardless of date submitted.

Type of Membership (check one): Fee (Add \$10 for Foreign Memberships) All Canadian & Foreign payments must be in U.S. Funds.

___ Renewal ___ New Membership

___ \$1,000 Life – Individual Only

___ \$1,000 Junior Life – Individual Only – Birth Date _____

___ \$55 *Annual Family/Firm – Immediate family unit consisting of parent/guardian and minor children (who have not reached their 18th birthday) or a corporation/firm or association. *List names below.

___ \$45 Annual – Individual Only

___ \$30 Annual Associate – Individual Only – *Limited Membership Privileges. No discount on registration & transfer fees; no vote; will not receive yearbook or be listed in the Member/Breeder Directory.

___ \$25 Annual Junior - Individual Only - Age 18 & Under - Birth Date _____. No vote; will not receive yearbook or be listed in the Member/Breeder Directory.

*Family/Firm membership please list individuals names, name of designated voter & dates of birth for children under 18.

_____	_____
_____	_____
_____	_____

*New members receive a literature packet: Member-breeder list, Welsh Pony Leaflet; Welsh Cob Brochure; Care/Feeding booklet; Fee Schedule; WPCSA Newsletter; WPCSA Rulebook & By-Laws; 3” WPCSA Window Decal.

Complete form & mail with fee to: Welsh Pony & Cob Society of America, Inc., 720 Green St., Stephens City, VA 22655

Amount Enclosed _____ or charge to my (circle one) Visa or MasterCard

Name as it appears on card _____

Card Number _____ 3-digit Security Code _____
(back of card)

Exp. Date _____ Signature _____

MEMBERSHIP

- a) Any person, firm or corporation owning or interested in Welsh ponies or cobs shall be eligible for membership.
- b) There shall be two (2) classes of membership: voting and non-voting.

Voting memberships are defined as follows:

- 1. Senior Life Membership – those persons who have reached their 18th birthday by January 1st of the current year.
- 2. Annual Membership – those persons who have reached their 18th birthday by January 1st of the current year.
- 3. Family/Firm – immediate family unit - parent/guardian and minor children (who have not reached their 18th birthday) or a corporation/firm or association. The Family/Firm unit will be entitled to only one vote.

Non-Voting Memberships shall be defined as follows:

- 4. Junior Life Membership – those persons who have not reached their 18th birthday by January 1st of the current year. Upon reaching 18, the membership will become Senior Life.
- 5. Annual Associates - those persons who have reached their 18th birthday by January 1st of the current year & who are interested in the breed but do not desire full membership privileges. No reduction of transfer & registration fees.
- 6. Junior Membership - those persons who have not reached their 18th birthday by January 1st of the current year.

Privileges WPCSA Members: Reduced registration and transfer fees (with the exception of Annual Associate members); Privilege of appearing in the Member-Breeder Directory (with the exception of Junior & Annual Associate members); Right to compete for High Score Awards; Subscription to quarterly WPCSA Welsh Review Newsletter. All new members receive a complimentary literature packet. New Life members receive a complimentary pin; new Annual, Family/Firm & Annual Assoc. members receive a complimentary three-inch decal; new Junior members receive a complimentary poster.

Note: Your dues or contribution to the association are not deductible as charitable contributions. Please consult with your tax advisor to determine whether they may be deducted under other provisions of the law (such as the provisions relating to the deductibility of business expenses).

Every entry at a WPCSA sanctioned show shall constitute an agreement and affirmation that all participants (which include without limitation the owner, lessee, trainer, manager, agent, coach, driver, rider handler and the horse) for themselves, their principals, representatives, employees and agents: 1) shall be subject to the rules of the WPCSA, The Oklahoma-Kansas Welsh Pony Society (OKWPS), and the Tulsa Area Pony Show (TAPS); 2) represent that every horse, rider, driver and handler is eligible as entered; 3) agree to be bound by the rules of the WPCSA, OKWPS and TAPS, and accept as final any decision of the WPCSA, OKWPS and TAPS on any questions arising under said rules and agree to hold the WPCSA, OKWPS and TAPS, their Officials, Directors and Employees harmless for any action taken; 4) agree that they participate voluntarily in the competition fully aware that equine sports and the competition involve inherent dangerous risks and by participating they expressly assume all risks of injury or loss and agree to indemnify and hold the WPCSA, OKWPS and TAPS, and their Officials, Directors, Employees, and Agents harmless from all claims including injury or loss during or in connection with the competition whether or not such injury or loss resulted, directly or indirectly, from negligent acts or omissions of said Officials, Directors, Employees, and Agents of the WPCSA, OKWPS and TAPS.

Each person signing this form acknowledges that he/she has read the above statement and agrees to the applicable terms, conditions, waivers and consent as set forth herein. Each person agrees that the information is accurate to best of his/her knowledge.

X _____
Signature of Exhibitor or Agent **and Signature of Parent or Guardian giving Permission for a Junior Exhibitor to Show**

Name of Junior Exhibitor _____ Date of Birth _____

Name of Junior Exhibitor _____ Date of Birth _____

Name of Junior Exhibitor _____ Date of Birth _____

The Members of the OKWPS wish each competitor and visitor the best of luck at our 2016 show!!!



Oklahoma-Kansas Welsh Pony Society ♦ Tulsa Area Pony Show

May 28-30, 2016 ♦ Claremore, OK Expo Center

Only one animal on each entry form. Entry form **MUST BE SIGNED** for entries to be accepted.

WPCSA Customer ID# _____

NAME OF OWNER _____

ADDRESS _____

PHONE _____

E-MAIL _____

Please send with entries:

- Copy of registration papers (front and back)
 - Copy of current measurement cards
- all Welsh and Half-Welsh in performance and all Welsh and Half-Welsh Breeding animals six years of age and older showing in WPCSA pointed classes **MUST** be measured or present valid (current) USEF or WPCSA measurement card.

A negative Coggins Test Certificate (current within one year of the show) must be presented to the Show Secretary upon arrival. No copies accepted.

NAME OF ANIMAL	COLOR	SEX	HEIGHT	AGE	WPCSA REG. #

SIRE NAME & REGISTRATION NUMBER:

DAM NAME & REGISTRATION NUMBER:

ENTRY NO. <small>(office use only)</small>	WRITE CLASS NUMBER BELOW NAME OF CORRESPONDING RIDER	RIDER'S DATE OF BIRTH														
	NAME OF RIDER > _____ WPCSA Customer ID# _____															
CLASSES >	<table border="1" style="width: 100%; border-collapse: collapse;"> <tr> <td style="width: 10%; height: 20px;"></td> <td style="width: 10%;"></td> <td style="width: 10%;"></td> <td style="width: 10%;"></td> <td style="width: 10%;"></td> <td style="width: 10%;"></td> <td style="width: 10%;"></td> <td style="width: 10%;"></td> <td style="width: 10%;"></td> <td style="width: 10%;"></td> <td style="width: 10%;"></td> <td style="width: 10%;"></td> <td style="width: 10%;"></td> <td style="width: 10%;"></td> </tr> </table>															
	NAME OF RIDER > _____ WPCSA Customer ID# _____															
CLASSES >	<table border="1" style="width: 100%; border-collapse: collapse;"> <tr> <td style="width: 10%; height: 20px;"></td> <td style="width: 10%;"></td> <td style="width: 10%;"></td> <td style="width: 10%;"></td> <td style="width: 10%;"></td> <td style="width: 10%;"></td> <td style="width: 10%;"></td> <td style="width: 10%;"></td> <td style="width: 10%;"></td> <td style="width: 10%;"></td> <td style="width: 10%;"></td> <td style="width: 10%;"></td> <td style="width: 10%;"></td> <td style="width: 10%;"></td> </tr> </table>															
	NAME OF RIDER > _____ WPCSA Customer ID# _____															
CLASSES >	<table border="1" style="width: 100%; border-collapse: collapse;"> <tr> <td style="width: 10%; height: 20px;"></td> <td style="width: 10%;"></td> <td style="width: 10%;"></td> <td style="width: 10%;"></td> <td style="width: 10%;"></td> <td style="width: 10%;"></td> <td style="width: 10%;"></td> <td style="width: 10%;"></td> <td style="width: 10%;"></td> <td style="width: 10%;"></td> <td style="width: 10%;"></td> <td style="width: 10%;"></td> <td style="width: 10%;"></td> <td style="width: 10%;"></td> </tr> </table>															

Entry Fee - Halter: \$12.50 per class (\$25.00 for both judges)	x _____	classes	= \$ _____
Entry Fee - Performance: \$15.00 per class	x _____	classes	= \$ _____
Weekend Stall Fee: \$50.00 per stall	x _____	stalls	= \$ _____
Single Day Stall Fee: \$25.00 per stall	x _____	stalls	= \$ _____
Tack Stall: \$50.00 per stall	x _____	stalls	= \$ _____
Measurement Fee: \$5.00 per head non-member of WPCSA	x _____	head	= \$ _____
WPCSA Recording Fee: \$5.00 per pony per judge (\$10 for the weekend/pony)	x _____	head	= \$ _____
Jump Fee: \$15.00 per pony	x _____	head	= \$ _____
Office Fee: \$15.00 per owner	x _____	owner	= \$ _____
make checks payable to: OKWPS		TOTAL ENCLOSED	\$ _____

Mail entries to:
Denise Dougherty
2030 Lakeview Road
Crescent, OK 73028

Stall with: _____

Arrival: Date _____ Time _____