



TAPS

30th Tulsa Area Pony Show

Sponsored by
Oklahoma-Kansas Welsh Pony Society

May 27-29, 2017

Claremore Expo Center
400 Veterans Parkway
Claremore, Oklahoma

Recognized by the
Welsh Pony & Cob Society of America
Double Gold Sanctioning Applied For



Oklahoma-Kansas Welsh Pony Society
Tulsa Area Pony Show
May 27, 28, 29, 2017

Location	Claremore Expo Center
Recognized by	Welsh Pony and Cob Society of America <i>WPCSA Provisional Double Gold</i>
Judges	Joann Williams, Elkhorn, Wisconsin (Show #1) Debbie Rash, Chino, California (Show #2)
Official Measurer	Connie Moore
Rules Commission <i>(All WPCSA rules apply)</i>	Daphne Dougherty, Ranae Smith Connie Moore
Course Designers	Driving Obstacle - Daphne Dougherty Hunter - Connie Moore Trail - Ranae Smith
Show Managers	Denise Dougherty, 580-402-6558 Ranae Smith, 918-798-2248
Farrier on Call	David Jackson, 918-396-1053
Veterinarian on Call	Andy Anderson, 918-252-7407
Secretary	Denise Dougherty, 580-402-6558
Stabling	Denise Dougherty, 580-402-6558

ENTRY CHECK LIST

- Entry form, both sides
- Proper fees ***made payable to: OKWPS***
- Copy of Registration papers of each pony/cob entered (front and back)
- Copy of measurement cards

Entry check list information is to be sent to:

Denise Dougherty 580-402-6558 (Denise cell)
2030 Lakeview Road 405-969-2073 (Denise home)
Crescent, OK 73028 denised0602@rocketmail.com

This show is conducted under the rules and regulations of the Welsh Pony & Cob Society of America, Inc. Points won will count toward WPCSA End of the Year Awards provided that owners, riders, and ponies are properly recorded and listed under their registered name and number.

Please send entries by May 14 to be included in the program.

Find us on Facebook @ OKWPS - Oklahoma Kansas Welsh Pony Society

Fees, Rules & Regs., Prize Monies 1

Fees: Entry Fee - Halter	\$25.00 for both judges
Entry Fee Performance	\$15.00 per class
Weekend Stall Fee	\$50.00 per stall
One Day Stall Fee	\$25.00 per stall
Measurement Fee	\$ 5.00 per head non-WPCSA member
WPCSA Recording Fee	\$ 5.00 per pony per judge (\$10 for weekend/pony)
Jump Fee	\$15.00 per pony
Office Fee	\$15.00 per owner

Post Entries: will be accepted at regular class fees.

Admission to Show: Free

Refunds: None

Returned Check Policy: If a check is returned unpaid, the show will assess a \$25.00 fee and a money order, cashiers check or cash must be presented to show management. No premiums will be paid until all delinquent funds are collected.

Office hours:

Noon to 7:00 pm - Friday.

7:00 am to close of show - Saturday, Sunday and Monday.

Show Check-in Requirements: All equine will be accompanied with a record of a negative official test for EIA (Coggins) conducted within the past 12 months. You must present the original form and not a copy upon arrival. Foals less than 6 months of age, accompanied by and nursing a negative tested mare are exempt from the testing requirements. This is a state law and show management will check papers when you arrive and if proper documentation is not present, you will not be permitted to remain on the grounds.

Measurements: All Welsh which do not possess a valid measurement card will be measured as required by the official measurer. Measurement will be Friday 7-9 pm. Alternate times will be posted. It is the owner's responsibility to make a measurement time. Animals five (5) and under shown only in halter are not subject to measurement.

Stalls and Bedding: Arrangements for access to stalls prior to 8:00 am Friday must make arrangements with Denise Dougherty (cell phone: 580-402-6558) to get into the stalls. **All bedding is in-house.** See Expo Center Rules on page 3.

Prize Monies: Total monies offered is \$1,245.00

Halter and Performance Champions (where indicated)	\$15 - \$10
All Breed Class Grand Champions and Supreme Gelding	\$25 - \$15
Supreme Champion.....	\$50 - \$25

Prize monies will be mailed within 60 days following the show.

Sanctioning: This is a Provisional Welsh Pony and Cob Society of America (WPCSA) Double Gold Show. All WPCSA classes will conform to the class specifications, which are included herein. Welsh performance championships are based on points only, no entry fees are required for those classes. To qualify for entry in Stake classes, the exhibitor must enter and compete in at least one other class in the division.

Classes: Show management reserves the right, with permission of the exhibitors, to cancel classes that have no entries, or to divide the classes in which the entries cannot be accommodated in the ring at one time, and to make such changes in the class schedule as dictated by the interest of the show. If there are 8 or more 12.2 and under and 8 or more over 12.2 to 14.2 hand ponies in any WPCSA class, it will be split. Classes are open to stallions, mares and geldings. WPCSA classes of less than three entries will receive reduced points and will not be combined.

2 Rules & Regulations

Breed Specifications: *Section A Welsh Pony* - Not exceeding 12.2 hands
 Section B Welsh Pony - Not exceeding 14.2 hands
 Section C Welsh Pony of Cob Type - 13.2 hands & under
 Section D Welsh Cob - Over 13.2 hands
 Small Pony - 12.2 hands and under
 Medium/Large Pony - Over 12.2 hands, not exceeding 14.2 hands

Attire: Riders must be properly attired according to the rules of the division in which they are competing. Riders in all classes where jumping is required, and when jumping elsewhere on the show grounds, must wear protective headgear. Numbers must be worn and be clearly visible.

Adult Exhibitors: An individual who has reached their 18th birthday as of December 1st of the current competition year.

Junior Exhibitors: An individual who has not reached their 18th birthday as of December 1st of the current competition year. When dividing junior divisions into two separate age groups, they will be split as follows: youth 12 & under and youth 13 and over (but have not reached their 18th birthday by December 1st of the current competition year. Juniors under 14 years of age cannot show a stallion. Junior Drivers under 14 years of age must have an experienced adult (over 18) in the carriage at all times. **Junior exhibitors must wear approved protective headgear (ASTM/SEI) at all times whenever mounted or in a driven vehicle at all times while on the show ground. Harness must be secured and properly fitted. Any rider violating this rule at any time must immediately be prohibited from further riding until such headgear is properly in place.**

Area Motels: Comfort Inn, 1750 S. Lynn Riggs Blvd. 918-343-3297 and Microtel, 918-343-2868. Due to two other large events in the area, we were unable to secure a block of rooms at a special rate.

Facilities: Claremore Expo Center has a 135'x265' Indoor Dirt Arena with bleacher seating, a 120'x210' Covered Arena with attached stall barn. Access to Indoor Arena is by covered walkway.

Concessions: Concessions on the show grounds are open from 7:30am to 6pm.

R.V. Hook-ups: The facility RV Park has full hook-ups and on-site dry camping on a nightly fee basis. It also boasts amenities such as BBQ grills, picnic tables, showers and laundry service, and a playground. Contact RV Park Manager for information (918) 342-5357 ext. 200.

Super Rec Center: Located across from the RV Park, the Super Rec Center has an Olympic size swimming pool, walking track, basketball courts, etc.

Expo Center Rules

Parking: Parking in front and side of the barns is restricted due to fire safety regulations and to allow exhibitors to pass from the stabling area to the show arena safely. Vehicles parked in restricted areas are subject to towing.

Bedding: Shavings are \$7.00 per bag (price subject to change based on the cost and availability of shavings.) One bag minimum is required with stall rental. ***Absolutely No Outside Bedding Allowed.***

Dog Policy: No dogs shall be allowed into the facility, except for those certified to assist the physically challenged. Only dogs on leashes shall be allowed in the exercise area or stall barn area.

Stalling: All animals entered or brought to events would ideally be stalled in the livestock facilities. No Jump-offs allowed. A minimum of one bag of bedding shall be required per stall. Barns and stalls are for the use of contracted facility events only.

No Taping, tacking stapling, nailing, gluing etc. on walls or other painted surfaces.

Smoking: The facility is a smoke-free facility. This includes the Exhibit Hall, Arena and Horse Barn. No smoking is allowed inside the buildings. Designated smoking sections are stationed outside the facilities.

Rules / Class Specifications 3

LIVESTOCK ANIMALS AND INHERENT RISK Persons engaged in livestock activities on the Claremore EXPO CENTER premises assume all risks associated with the inherent in the participation of such activities. The Claremore Cultural Development Authority and/or The city of Claremore shall not be responsible in any manner for injuries and/or damages, either seen or unforeseen, sustained by any person engaged in livestock activities on said premises as provided for under Oklahoma Law.

Class Specifications

WPCSA BREED CLASSES (Article 110.2) Animals are to be shown in hand at a walk and a trot except in group classes. Purebred Welsh to be judged 85% on breed type, conformation, way of going, quality and substance and 15% on disposition and manners. Natural reaching action is desired. Half-Welsh and Part Breds to be judged 85% on conformation, way of going, quality and substance and 15% on Welsh breed type, disposition and manners.

offered in both Shows

WPCSA WELSH ENGLISH PLEASURE (Article 112.3) To be shown at a walk, trot and canter both ways of the ring on light contact without a martingale. To be judged 75% on performance, manners, movement and style; 25 % on breed type and conformation. Working class to be judged 100% on performance.

offered in both Shows

WPCSA WELSH WESTERN PLEASURE (Article 112.4) To be shown at a walk, jog and lope both ways of the ring without a martingale, on a reasonably loose rein, without undue restraint. To be judged on performance, with emphasis on manners 65%; breed type, conformation and movement 25%; appointments 10%. Working classes are judged 100% on performance.

offered in Show #1 only

WPCSA WELSH HUNTER (Article 112.5) To be judged 75% on performance, manners, movement and style; 25% on breed type and conformation. Working classes judged 100% on performance. Animals not exceeding 13.2 hands will jump 2'.0"; animals exceeding 13.2 shall jump 2'6". Over fences (o/f): To be shown over a course of a minimum of **six** fences with eight jumping efforts of the required height. Under saddle (u/s): To be eligible, pony must have shown in and completed an over fence class. To be shown at the walk, trot and canter both ways of the ring. **May be required to hand gallop one way of the ring, but no more than eight animals at one time.**

offered in both Shows

WPCSA SHORT STIRRUP HUNTER (Article 112.6) Division is open to riders 12 years & under. Classes are open to all Ponies/Cobs/Half-Welsh/Part Bred, mares and geldings. **RIDERS** in this division, including the under saddle class, may not compete over fences in any other division except Short Stirrup Equitation. Courses to be set at 18" with a minimum of 4 fences with 8 jumping efforts required. May either trot or canter the course. Over-fence classes must precede the under-saddle class. To be judged 100% on performance. To be eligible for the under-saddle class, animal must have shown in **and completed** an over-fences class. Under-saddle class animals will be shown both ways of the ring at a walk, trot and canter. Not required to jog for over-fences classes.

offered in both Shows

WPCSA LOW HUNTER 18" or 2' (Article 112.8) Division is open to Ponies/Cobs and Half-Welsh/Part Breds, Juniors and Adults. These **ANIMALS** may not compete in any other over fences division at that show where fence heights exceed 18". There are no restrictions on the rider unless they are restricted by other class rules. Long Stirrup riders are eligible if jumping 18" but Short Stirrup riders are not eligible to compete. Courses to be set at 18" or 2' with a minimum of 4 fences with 8 jumping efforts required. Jumps must be verticals (no cross rails). Riders may choose to jump 18" or 2'. Fence heights are not determined by the height of the animal. No animal may jump both 18" and 2" in this division at the same show. Over-fences classes must precede the under-saddle classes. To be judged 100% on performance. May either trot or canter the course. Not required to jog for over-fences classes.

offered in both Shows

WPCSA HUNTER SEAT EQUITATION (Article 114.3) Classes open to Ponies/Cobs/Half-Welsh/Part Breds. To be judged on the rider's appearance, seat, hands and control and of their mount. Animals 13.2 and under jump 2'; animals over 13.2 jump 2'6". Over-fences (o/f) classes: to be shown over a minimum of six obstacles. Under-saddle (u/s) classes: To be shown at walk, trot and canter both ways of the ring. Tests may be required.

offered in both Shows

4 Class Specifications

Removing the bridle from an animal harnessed to a vehicle, or leaving an animal unattended while hitched, anywhere on the show grounds, will result in instant elimination and removal from the show grounds.

WPCSA PLEASURE DRIVING (Article 113.1) To be shown to a suitable two or four-wheeled vehicle or four-wheeled vehicle for pairs, but not a viceroy, racing sulky or fine harness rig. Use of a bike style vehicle with floorboards and a basket is acceptable. To be shown both ways of the ring at a walk, working trot and trot on and stand quietly and except for tandems, **to back readily**. A properly attired groom or passenger *capable of rendering assistance in case of emergency* is required for all pairs and tandems; unicorns and four-in-hands require 2 grooms/passengers. Failure to comply will result in elimination from the class. To be judged 75% on performance, manners, movement and style; 25% on breed type and conformation. Working classes are judged 100% on performance.

offered in both Shows

WPCSA CARRIAGE DRIVING (Article 113.2) (wire-wheeled vehicles may be used at this show) Classes open to Ponies/Cobs/Half-Welsh/Part Breds. To be shown both ways of the ring at a walk, slow trot, working trot and strong trot. To stand quietly, both on the rail and while lined up, and to rein back. In the slow trot the animal should maintain forward impulsion while showing submission to the bit. A properly attired groom or passenger *capable of rendering assistance in case of an emergency* is required for all pairs and tandems; unicorns and four-in-hands require 2 grooms/passengers. Failure to comply will result in elimination from the class.

offered in both Shows

WPCSA CARRIAGE DRIVING TURNOUT (Article 113.2.3) To be judged primarily on the performance and quality of each turnout. To be shown both ways of the ring at a walk, slow trot, working trot and strong trot. To stand quietly, both on the rail and while lined up, and to rein back. To be judged 70% on the condition, fit and appropriateness of harness and vehicle, neatness and appropriateness of attire and overall impression: 30% on performance, manners and way of going.

WPCSA CARRIAGE DRIVING WORKING (Article 113.2.3) To be judged primarily on the suitability of the animal to provide a pleasant drive. To be shown both ways of the ring at a walk, slow trot, working trot and strong trot. To stand quietly, both on the rail and while lined up, and to rein back. May be asked to execute appropriate tests. To be judged 70% on performance, manners and way of going; 20% on the condition and fit of harness and vehicle; 10% on neatness of attire.

WPCSA OBSTACLE/CONES DRIVING (Article 113.2.3) Obstacle/Cones to be judged 100% on performance. Course plan must be announced and posted one hour before competition is to begin. Competitors may walk the course. Martingales and overchecks are prohibited in obstacle classes for all vehicles. Side checks are optional. Failure to comply incurs elimination. Refer to specifications in rulebook (Article 113.2.3) for the type of obstacle/cones classes being offered. See Article 113.2.2.7 for definition of break in gait.

WPCSA Obstacle - Time Competition

Not to exceed 20 obstacles (pairs of cones topped with tennis balls). Faults add seconds to total time. Fastest time wins.

1. To be driven over a prescribed course of obstacles. The number of obstacles to be proportionate to the dimensions of the driving area. Not to exceed 20 obstacles.
2. After passing the starting line, the driver shall proceed through each obstacle in order to the designated finish line.
3. Course faults are scored as penalty seconds and are added to the driver's elapsed time. Placings are determined on a low total time basis. Ties for first will be decided by a drive-off (unless otherwise stated in the prize list).
4. Penalties:
 - a) Exceeding time allowed (every commenced second) 0.5 second
 - b) Knocking over start or finish marker 5 seconds
 - c) Knocking down or dislodging obstacle 5 seconds
 - d) Break in gait, if not allowed
 - 1st break from trot 5 seconds
 - 2nd break from trot 5 seconds
 - 3rd break from trot 5 seconds
 - 4th break from trot Elimination
 - Prolonged canter or walk Elimination
 - e) Disobedience and/or groom dismounting (cumulative over course)
 - 1st incident 5 seconds
 - 2nd incident 10 seconds
 - 3rd incident Elimination
 - f) Starting before signal Elimination
 - g) Failure to cross starting line within one minute of signal Elimination
 - h) Off course Elimination
 - i) Exceeding time limit (2X time allowed) Elimination
 - j) Outside assistance Elimination

Class Specifications 5

- k) Failure to carry whip Elimination
- l) Use of a tie-down or overcheck Elimination
- m) Breakage of harness or vehicle Elimination

WPCSA Roadster (12.2 & under) (Article 113.4) For Section A and B ponies 12.2 and under. Roadster must enter the ring clockwise at a jog-trot then show at the Road Gait; turn counter clockwise at the jog-trot, show at the Road Gait and then trot at speed. Must stand well while being judged in the line up. In the event of a work-off, entries chosen must work both ways of the ring, as the original routine. To be judged 75% on performance, manners, style and speed in form; 25% on breed type. Working class to be judged 100% on performance.

offered in Show #2 only

LEADLINE CLASS SPECIFICATIONS (Article 115.4.1) In all Leadline classes the leadline is to be attached to the cavesson on the English bridle and on the Western bridle to the cheek slot of the bit (top of the bit). No chain leadlines allowed.

WPCSA LEADING REIN (Article 115.1) 12/1/2016 Section A, B, C or Half-Welsh/Part Breds, mare or gelding, 12.2 hands and under, to be ridden by junior exhibitors at least four, but not more than eight, years of age. To be shown on light contact and led by an adult. The leading rein to be attached to the cavesson on the English bridle or to a noseband, cavesson or halter with a Western bridle while leaving control of the pony to the child. No chain leadlines allowed. To be shown at a walk, on the right rein (clockwise), to line up and stand quietly. Ponies will be called out individually to stand, walk out and trot or jog back past the judge. Ponies to be judged on manners, suitability, breed type, conformation and turn-out. This is not an equitation class. **There are no restrictions for the pony or rider.**

offered in Show #1 only

WPCSA CHILD'S FIRST PONY (Article 115.2) Section A, B, C, Half-Welsh or Part Bred, mare or gelding 12.2 hands and under, to be ridden by junior exhibitors at least four, but no more than 10, years of age. Riders to be suitably dressed in Hunt, Saddle or Western attire including protective headgear. Ponies to be shown at a walk and trot or jog, both ways of the ring. **Ponies to be judged** on performance, manners and suitability. Conformation, way of going, manners, suitability and turnout to be emphasized. This is not an equitation class. **There are no restrictions for the pony or rider.**

offered in Show #1 only

WPCSA TRAIL (Article 115.3) Open to all Ponies/Cobs/Half-Welsh/Part Breds. Junior and adult (separate divisions are to be offered for juniors and adults). English or Western equipment. To be shown over and through obstacles at a walk, optional trot or jog and optional canter or lope. To be judged 100% on performance.

offered in Show #2 only

WPCSA LEADLINE WALK (Article 115.4) 12/1/2016 Classes open to riders 7 & under mounted on Ponies/Cobs / Half-Welsh/Part Breds, mares and geldings. The leading rein to be attached to the cavesson on the English bridle or to a noseband, cavesson or halter with a Western bridle while leaving control of the pony to the child. No chain leadlines allowed. Judged on equitation and suitability of mount at a walk. To stand quietly. To be led by an adult or a junior age 12 or over. Both handler and rider to be appropriately attired. English or Western attire is acceptable. No chain leadlines. **RIDERS** ineligible for other ridden classes except costume, leading rein, leadline walk-trot, and leadline walk-trot poles.

offered in Show #1 only

WPCSA LEADLINE WALK-TROT (Article 115.4) 12/1/2016 Classes open to riders 7 & under mounted on Ponies/Cobs / Half-Welsh/Part Breds, mares and geldings. The leading rein to be attached to the cavesson on the English bridle or to a noseband, cavesson or halter with a Western bridle while leaving control of the pony to the child. No chain leadlines allowed. Judged on equitation and suitability of mount at a walk and trot/jog. To stand quietly. To be led by an adult or a junior age 12 or over. Both handler and rider to be appropriately attired. English or Western attire is acceptable. No chain leadlines. **RIDERS** ineligible for other ridden classes except costume, leading rein, leadline walk and leadline walk-trot poles.

offered in Show #1 only

WPCSA WALK (Article 115.5) Classes open to riders 11 & under mounted on Ponies/Cobs/Half-Welsh/Part Breds, mares and geldings. Judged on equitation and suitability of mount. English or Western attire is acceptable. **RIDERS** ineligible for other ridden classes except costume, leading rein, child's first pony, walk-trot and walk-trot poles. To walk both ways of the ring.

offered in Show #1 only

WPCSA WALK-TROT (Article 115.5) Classes open to riders 11 & under mounted on Ponies/Cobs/Half-Welsh/Part Breds, mares and geldings. Judged on equitation and suitability of mount. To walk and trot/jog both ways of the ring. Possible test to include: walk, trot/jog, turn, halt and rein back at spots marked. English or Western attire is acceptable. **RIDERS** ineligible for other ridden classes except costume, leading rein, child's first pony, walk and walk-trot poles.

offered in Show #1 only

6 Class Specifications

WPCSA WALK-TROT POLES (Article 115.5) Classes open to riders 11 & under mounted on Ponies/Cobs/Half-Welsh/Part Breds, mares and geldings. Judged on equitation and suitability of mount. To be ridden once around a course of four poles on the ground entirely at a walk or entirely at a trot/jog. Poles are to be placed at a minimum of 4 feet off the rail, two on each side of the ring, simulating a hunter course. The poles should be placed far enough away from the entrance gate to provide an adequate sized area to do an opening and closing circle. English or Western attire is acceptable. **RIDERS** ineligible for other ridden classes except costume, leading rein, child's first pony, walk and walk-trot.

offered in Show #1 only

WPCSA JUNIOR WELSH HANDLER (Article 115.6) 12/1/2016 Class open to juniors handling Ponies/ Cobs/ Half-Welsh/ Part Breds mares and geldings. Judged on the ability and skill of the Junior in handling their animal as in the breed ring. The show qualities of the animal shall not be considered, although cleanliness and grooming can be considered. Exhibitors enter to the left so as not to obscure the judge's view. The ring procedure should be the same routine used when judging standard halter classes. The judge evaluates the ability of the junior to follow directions, use space wisely, and execute the requested patterns. Juniors should appear "ring wise", be alert to the judging progression and be prepared for changes in the judging routine. This is not a showmanship class and a showmanship pattern should not be used.

offered in Show #2 only

WPCSA RIDDEN WELSH CLASSIC SEC. C & D (Article 115.7) This class is for registered Welsh Cobs and Welsh Ponies of Cob Type 4 years of age and over. To be judged 50% on conformation and 50% on performance. Entries shall enter the arena in a clockwise direction. To be shown on both reins as a group at the walk, trot, and canter with animation. The required individual performance must show all four gaits (the gallop need only be shown in one direction). Each animal will then be stripped and judged for conformation judging, showing at the walk and trot, in hand, by the rider. Once an entry has been judged for conformation it may be retacked. Class is an English class only. No Western, Saddle Seat or Side Saddle tack or attire. Qualified UK or American Judge to officiate.

offered in Show #2 only

WPCSA RIDDEN WELSH CLASSIC SEC. A & B (Article 115.7) This class is for registered Welsh Ponies, Section A & B, 4 years of age and over. To be judged 50% on conformation and 50% on performance. Entries shall enter the arena in a clockwise direction. To be shown on both reins as a group at the walk, trot, and canter with animation. The required individual performance must show all four gaits (the gallop need only be shown in one direction). Each animal will then be stripped and judged for conformation judging, showing at the walk and trot, in hand, by the rider. Once an entry has been judged for conformation it may be retacked. Class is an English class only. No Western, Saddle Seat or Side Saddle tack or attire. Qualified UK or American Judge to officiate.

offered in Show #2 only

WPCSA RIDDEN WELSH CLASSIC CHAMPIONSHIP CLASS (Article 115.7) To be judged 50% on conformation and 50% on ridden performance. Open to first and second place winners from Ridden Welsh A/B Classic and the Ridden Welsh C/D Classic. There is no entry fee for this class. Places will be awarded for the Best Ridden and the Reserve Best Ridden. Any animal in this class is eligible to be named the Best Ridden. Entries shall enter the arena in a clockwise direction. The Judge shall request all four gaits (walk, trot, canter, gallop) in at least one direction, but animals need not show in both directions. The judge shall consider the size of the ponies/cobs, ages of riders, safety of arena when determining whether to have the animals perform as a group or individually. Individual pattern is optional at the judge's discretion. Entries shall not be stripped as conformation score from the qualifying class shall be carried forward.

offered in Show #2 only

WPCSA WALK-TROT ADULT EQUITATION (Article 115.8) Class open to riders 18 years of age and older on ponies, cobs, Half-Welsh or Part Breds. English or Western attire is acceptable. Riders ineligible for any other WPCSA pointed ridden class at that show. Judged on equitation and suitability of mount. To walk and trot or jog both ways of the ring. Possible tests to include: walk, trot or jog, turn, halt and rein back at spots marked.

offered in Show #1 only

NON-POINTED CLASSES

WALK-TROT TRAIL (Article 116.6) Open to riders 11 & under mounted on Ponies/Cobs/Half-Welsh/Part Breds, mares and geldings. To be shown over and through obstacles at a walk, optional trot or jog and optional canter or lope. To be judged 100% on performance. Pattern will not include a side pass or loping/cantering over loose rails.

offered in Show #2 only

PET PONY OBSTACLE Safety is a primary concern and suitability of child to pony will be emphasized. Child will lead pony over and around obstacles demonstrating their ability to control and maneuver the pony in a safe manner. Attire is not to be considered in judging unless considered unsafe. Adults or older juniors may accompany child and pony in the ring.

offered in Show #1 only

Saturday Performance 7

Show #1 - Saturday, May 27, 2017 8:00 am Judge: Joann Williams

Inside Arena hunter course available for warm-up and schooling

Outdoor Covered Arena

- 1 WPCSA Leadline Walk, Child 7 and under
- 2 WPCSA Leadline Walk-Trot, Child 7 and under
- 3 WPCSA Leading Rein, Child 4-8
- 4 WPCSA Child's First Pony, 12.2 & under, Child 4-10
- 5 WPCSA Walk, Child 11 and under
- 6 WPCSA Walk-Trot, Child 11 and under
- 7 WPCSA Walk-Trot Poles, Child 11 & under
- 8 Pet Pony Obstacle, Child 11 and under (class will be split if entries warrant)

Outdoor Covered Arena will have schooling jumps set up

Inside Arena

- 9 Warmup Working Hunter

- 10 WPCSA Working Hunter Over Fences, C/D, Junior/Adult
- 11 WPCSA Conformation Hunter Stake Over Fences, C/D, Junior/Adult
- 12 WPCSA Conformation Hunter Under Saddle, C/D, Junior/Adult
- 13 Champion and Reserve C/D Hunter, Junior/Adult \$15 - \$10

- 14 WPCSA Working Hunter Over Fences, A/B, Junior
- 15 WPCSA Conformation Hunter Stake Over Fences, A/B, Junior
- 16 WPCSA Conformation Hunter Under Saddle, A/B, Junior
- 17 Champion and Reserve A/B Hunter, Junior \$15 - \$10

- 18 WPCSA Working Hunter Over Fences, Half-Welsh/Part Bred, Junior/Adult
- 19 WPCSA Conformation Hunter Stake Over Fences, Half-Welsh/Part Bred, Junior/Adult
- 20 WPCSA Conformation Hunter Under Saddle, Half-Welsh/Part Bred, Junior/Adult
- 21 Champion and Reserve Half-Welsh/Part Bred Hunter, Junior/Adult \$15 - \$10

- 22 WPCSA Working Hunter Over Fences, A/B, Adult
- 23 WPCSA Conformation Hunter Stake Over Fences, A/B, Adult
- 24 WPCSA Conformation Hunter Under Saddle, A/B, Adult
- 25 Champion and Reserve A/B Hunter, Adult \$15 - \$10

- 26 Warmup Working Hunter (Low and Short Stirrup)

- 27 WPCSA Low Working Hunter Over Fences 18" or 2', Junior/Adult
- 28 WPCSA Low Working Hunter Stake Over Fences 18" or 2', Junior/Adult
- 29 WPCSA Low Working Hunter Under Saddle, Junior/Adult
- 30 Champion and Reserve Low Hunter Junior/Adult \$15 - \$10

- 31 WPCSA Short Stirrup Working Hunter Over Fences 12 & under
- 32 WPCSA Short Stirrup Working Hunter Stake Over Fences 12 & under
- 33 WPCSA Short Stirrup Working Under Saddle 12 & under
- 34 Champion and Reserve Short Stirrup Hunter 12 & under \$15 - \$10

8 Saturday Performance

Outdoor Covered Arena will be available for warm-up

Inside Arena (after jumps are removed)

- 35 WPCSA Hunter Seat Equitation On the Flat A/B/C/D/H/PB Junior

- 36 WPCSA Conformation English Pleasure, C/D, Junior/Adult
- 37 WPCSA English Pleasure Working, C/D, Junior/Adult

- 38 WPCSA Conformation English Pleasure, A/B, Adult
- 39 WPCSA English Pleasure Working, A/B, Adult

- 40 WPCSA Conformation English Pleasure Stake, C/D, Junior/Adult
- 41 Champion and Reserve English Pleasure, C/D, Junior/Adult \$15 - \$10

- 42 WPCSA Conformation English Pleasure Stake, A/B, Adult
- 43 Champion and Reserve English Pleasure, A/B, Adult \$15 - \$10

- 44 WPCSA Conformation English Pleasure, Half-Welsh/Part Bred, Junior/Adult
- 45 WPCSA English Pleasure Working, Half-Welsh/Part Bred, Junior/Adult

- 46 WPCSA Conformation English Pleasure, A/B, Junior
- 47 WPCSA English Pleasure Working, A/B, Junior

- 48 WPCSA Conformation English Pleasure Stake, Half-Welsh/Part Bred, Junior/Adult
- 49 Champion and Reserve English Pleasure, Half-Welsh/Part Bred, Junior/Adult \$15 - \$10

- 50 WPCSA Conformation English Pleasure Stake, A/B, Junior
- 51 Champion and Reserve English Pleasure, A/B, Junior \$15 - \$10

Inside Arena will be available for driving warm-up

Outdoor Covered Arena

- 52 WPCSA Walk-Trot Adult Equitation

- 53 WPCSA Conformation Western Pleasure, C/D, Junior/Adult
- 54 WPCSA Western Pleasure Working, C/D, Junior/Adult

- 55 WPCSA Conformation Western Pleasure, A/B, Adult
- 56 WPCSA Western Pleasure Working, A/B, Adult

- 57 WPCSA Conformation Western Pleasure Stake, C/D, Junior/Adult
- 58 Champion and Reserve Western Pleasure, C/D, Junior/Adult \$15 - \$10

- 59 WPCSA Conformation Western Pleasure Stake, A/B, Adult
- 60 Champion and Reserve Western Pleasure, A/B, Adult \$15 - \$10

- 61 WPCSA Conformation Western Pleasure, Half-Welsh/Part Bred, Junior/Adult
- 62 WPCSA Western Pleasure Working, Half-Welsh/Part Bred, Junior/Adult

Sat. Performance / Sunday Halter 9

- 63 WPCSA Conformation Western Pleasure, A/B, Junior
- 64 WPCSA Western Pleasure Working, A/B, Junior

- 65 WPCSA Conformation Western Pleasure Stake, Half-Welsh/Part Bred, Junior/Adult
- 66 Champion and Reserve Western Pleasure, Half-Welsh/Part Bred, Junior/Adult . . . \$15 - \$10

- 67 WPCSA Conformation Western Pleasure Stake, A/B, Junior
- 68 Champion and Reserve Western Pleasure, A/B, Junior \$15 - \$10

Outdoor Covered Arena will be available for driving warm-up and holding area

Inside Arena

- 69 WPCSA Carriage Driving Turnout, A/B/C/D/H/PB
- 70 WPCSA Carriage Driving Working, A/B/C/D/H/PB

- 71 WPCSA Conformation Pleasure Driving, Sec. C & D
- 72 WPCSA Conformation Pleasure Driving, Sec. A & B 14.2 & under

- 73 WPCSA Pleasure Driving Working, Sec. C & D
- 74 WPCSA Pleasure Driving Working, Sec. A & B 14.2 & under

- 75 WPCSA Conformation Pleasure Driving Stake, Sec. C & D
- 76 WPCSA Conformation Pleasure Driving Stake, Sec. A & B 14.2 & under

- 77 Champion and Reserve Pleasure Driving C & D \$15 - \$10
- 78 Champion and Reserve Pleasure Driving A & B \$15 - \$10

- 79 WPCSA Obstacle/Cones - Time Competition, A/B/C/D/H/PB
- 80 Champion and Reserve Carriage Driving A/B/C/D/H/PB \$15 - \$10

Breeding Classes - Sunday, May 28, 2017 9:00 a.m.

Show #1 Judge: Joann Williams and Show #2 Judge: Debbie Rash

Inside Arena available for warm-up and schooling

Outdoor Covered Arena

Half-Welsh/Part Bred

- 101 & 201 WPCSA Half-Welsh/Part Bred, 2 & under
- 102 & 202 WPCSA Half-Welsh/Part Bred, Mares 3 & over
- 103 & 203 WPCSA Half-Welsh/Part Bred, Geldings & Stallions 3 & over
- 104 & 204 WPCSA Senior Champion and Reserve Half-Welsh/Part Bred
- 105 & 205 WPCSA Grand-Champion and Reserve Half-Welsh/Part Bred \$25 - \$15

Geldings

- 106 & 206 WPCSA Section B Gelding, any age
- 107 & 207 WPCSA Section A Gelding, any age
- 108 & 208 WPCSA Section C & D Gelding, any age
- 109 & 209 WPCSA Supreme Champion and Reserve Gelding \$25 - \$15

10 Sunday Halter & Performance

Fillies

- 110 & 210 WPCSA Section B Fillies, 2 & under
- 111 & 211 WPCSA Section A Fillies, 2 & under
- 112 & 212 WPCSA Section C & D Fillies, 2 & under

Mares

- 113 & 213 WPCSA Section B Mares, 3 & over
- 114 & 214 WPCSA Section A Mares, 3 & over
- 115 & 215 WPCSA Section C & D Mares 3 & over

Colts

- 116 & 216 WPCSA Section B Colts, 2 & under
- 117 & 217 WPCSA Section A Colts, 2 & under
- 118 & 218 WPCSA Section C & D Colts, 2 & under

Stallions

- 119 & 219 WPCSA Section B Stallions, 3 & over
- 120 & 220 WPCSA Section A Stallions 3 & over
- 121 & 221 WPCSA Section C & D Stallions 3 & over

- 122 & 222 WPCSA Grand Champion and Reserve Section B \$25 - \$15
- 123 & 223 WPCSA Grand Champion and Reserve Section A \$25 - \$15
- 124 & 224 WPCSA Grand Champion and Reserve Section C & D \$25 - \$15

- 125 & 225 WPCSA Supreme Champion and Reserve \$50 - \$25

Classes for all sections will be split if numbers warrant

- 226 WPCSA Junior Welsh Handler, Child 13-17
- 227 WPCSA Junior Welsh Handler, Child 12 and under

Show #2 Sunday, May 28, 2017 Judge: Debbie Rash

Outdoor Covered Arena available for warm-up and schooling until Trail is set-up

Inside Arena

- 228 WPCSA Working Roadster, Sec. A & B 12.2 & under, Junior/Adult

- 229 WPCSA Ridden Welsh Classic A/B
- 230 WPCSA Ridden Welsh Classic C/D
- 231 WPCSA Ridden Welsh Classic Championship

- 232 WPCSA Carriage Driving Turnout A/B/C/D/H/PB
- 233 WPCSA Carriage Driving Working A/B/C/D/H/PB

- 234 WPCSA Conformation Pleasure Driving, Sec. C & D
- 235 WPCSA Conformation Pleasure Driving, Sec. A & B 14.2 & under

- 236 WPCSA Pleasure Driving Working, Sec. C & D
- 237 WPCSA Pleasure Driving Working, Sec. A & B 14.2 & under

Sunday & Monday Performance 11

- 238 WPCSA Conformation Pleasure Driving Stake, Sec. C & D
239 WPCSA Conformation Pleasure Driving Stake, Sec. A & B 14.2 & under
- 240 Champion and Reserve Pleasure Driving C & D \$15 - \$10
241 Champion and Reserve Pleasure Driving A & B \$15 - \$10
- 242 WPCSA Obstacle/Cones - Time Competition, A/B/C/D/H/PB
243 Champion and Reserve Carriage Driving A/B/C/D/H/PB \$15 - \$10
- 244 WPCSA Conformation Roadster, Sec. A & B 12.2 & under, Junior/Adult

Outdoor Covered Arena

- 245 WPCSA Trail, A/B/C/D/H/PB, Adult
246 WPCSA Trail, A/B/C/D/H/PB, Junior
247 Walk-Trot Trail 11 & under

Show #2 Monday, May 29, 2017 Judge: Debbie Rash

Outdoor Covered Arena will have schooling jumps set up

Inside Arena

- 248 WPCSA Working Roadster, Sec. A & B 12.2 & under, Junior/Adult
249 Champion and Reserve Roadster \$15 - \$10
- 250 Warm-up Working Hunter
- 251 WPCSA Working Hunter Over Fences, C/D, Junior/Adult
252 WPCSA Conformation Hunter Stake Over Fences, C/D, Junior/Adult
253 WPCSA Conformation Hunter Under Saddle, C/D, Junior/Adult
254 Champion and Reserve C/D Hunter, Junior/Adult \$15 - \$10
- 255 WPCSA Working Hunter Over Fences, Half-Welsh/Part Bred, Junior/Adult
256 WPCSA Conformation Hunter Stake Over Fences, Half-Welsh/Part Bred, Junior/Adult
257 WPCSA Conformation Hunter Under Saddle, Half-Welsh/Part Bred, Junior/Adult
258 Champion and Reserve Half-Welsh/Part Bred Hunter, Junior/Adult \$15 - \$10
- 259 WPCSA Working Hunter Over Fences, A/B, Junior
260 WPCSA Conformation Hunter Stake Over Fences, A/B, Junior
261 WPCSA Conformation Hunter Under Saddle, A/B, Junior
262 Champion and Reserve A/B Hunter, Junior \$15 - \$10
- 263 WPCSA Working Hunter Over Fences, A/B, Adult
264 WPCSA Conformation Hunter Stake Over Fences, A/B, Adult
265 WPCSA Conformation Hunter Under Saddle, A/B, Adult
266 Champion and Reserve A/B Hunter, Adult \$15 - \$10

12 Monday Performance

- 267 Warm-up Working Hunter (Low and Short Stirrup)
- 268 WPCSA Low Working Hunter Over Fences 18" or 2', Junior/Adult
- 269 WPCSA Low Working Hunter Stake Over Fences 18" or 2', Junior/Adult
- 270 WPCSA Low Working Hunter Under Saddle, Junior/Adult
- 271 Champion and Reserve Low Hunter \$15 - \$10

- 272 WPCSA Short Stirrup Working Hunter Over Fences 12 & under
- 273 WPCSA Short Stirrup Working Hunter Stake O/F 12 & under
- 274 WPCSA Short Stirrup Working Under Saddle 12 & under
- 275 Champion and Reserve Short Stirrup Hunter \$15 - \$10

Outdoor Covered Arena will be available for warm-up and schooling

Inside Arena

- 276 WPCSA Hunter Seat Equitation On the Flat A/B/C/D/H/PB Junior

- 277 WPCSA Conformation English Pleasure, C/D, Junior/Adult
- 278 WPCSA English Pleasure Working, C/D, Junior/Adult

- 279 WPCSA Conformation English Pleasure, A/B, Adult
- 280 WPCSA English Pleasure Working, A/B, Adult

- 281 WPCSA Conformation English Pleasure Stake, C/D, Junior/Adult
- 282 Champion and Reserve English Pleasure, C/D, Junior/Adult \$15 - \$10

- 283 WPCSA Conformation English Pleasure Stake, A/B, Adult
- 284 Champion and Reserve English Pleasure, A/B, Adult \$15 - \$10

- 285 WPCSA Conformation English Pleasure, Half-Welsh/Part Bred, Junior/Adult
- 286 WPCSA English Pleasure Working, Half-Welsh/Part Bred, Junior/Adult

- 287 WPCSA Conformation English Pleasure, A/B, Junior
- 288 WPCSA English Pleasure Working, A/B, Junior

- 289 WPCSA Conformation English Pleasure Stake, Half-Welsh/Part Bred, Junior/Adult
- 290 Champion and Reserve English Pleasure, Half-Welsh/Part Bred, Junior/Adult ... \$15 - \$10

- 291 WPCSA Conformation English Pleasure Stake, A/B, Junior
- 292 Champion and Reserve English Pleasure, A/B, Junior \$15 - \$10

13 Show Layout



Claremore is located NE of Tulsa on historic Route 66. The Expo Center is located in the heart of the city on State Highway 20 and Will Rogers Boulevard. The facility officially opened in December of 1999.

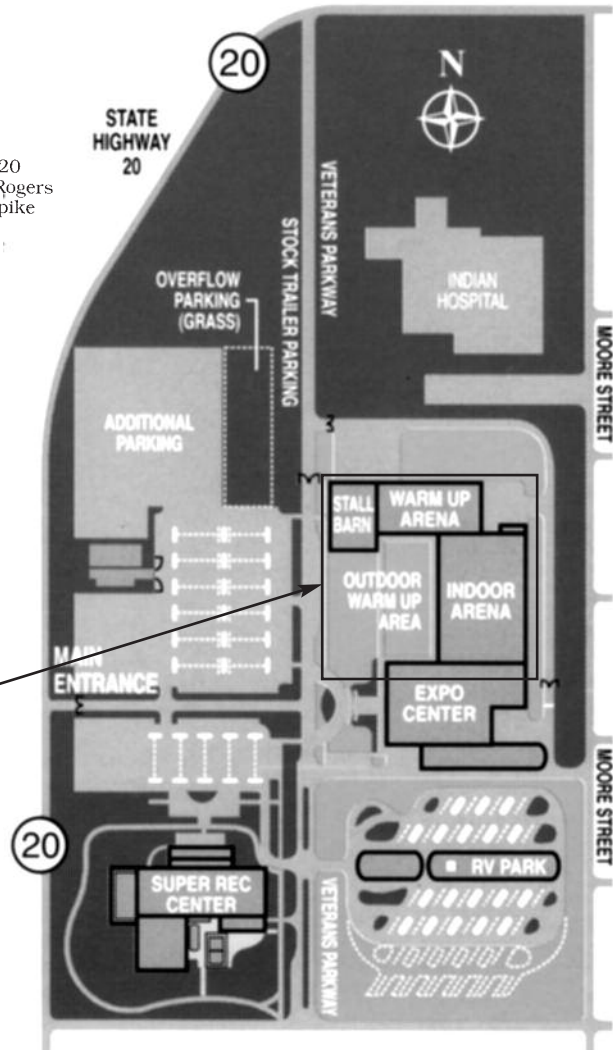
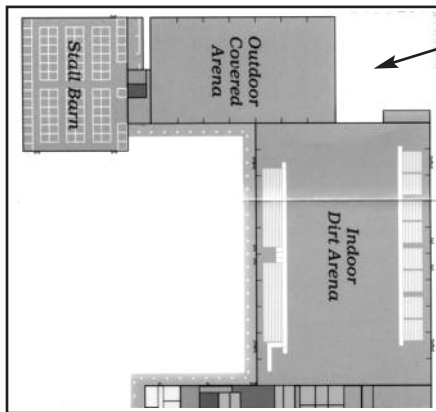

Under the Oklahoma law, an equine activity sponsor or equine professional is not liable for any injury of a participant in equine activities resulting from the inherent risks of equine activities pursuant to the Oklahoma Livestock Activities Liabilities Limitations Act.

WELSH PONY & COB SOCIETY OF AMERICA, INC. MEMBERSHIP APPLICATION

Applicant(s) Name _____

Address _____

City/State/Zip _____ Telephone _____

Email _____ Website _____

*NOTE: All Annual Memberships expire on December 31 of the current year, regardless of date submitted.

Type of Membership (check one): Fee (Add \$10 for Foreign Memberships) All Canadian & Foreign payments must be in U.S. Funds.

___ Renewal ___ New Membership

___ \$1,000 Life – Individual Only

___ \$1,000 Junior Life – Individual Only – Birth Date _____

___ \$60 *Annual Family/Firm – Immediate family unit consisting of parent/guardian and minor children (who have not reached their 18th birthday) or a corporation/firm or association. *List names below.

___ \$50 Annual – Individual Only

___ \$35 Annual Associate – Individual Only – *Limited Membership Privileges. No discount on registration & transfer fees; no vote; will not receive yearbook or be listed in the Member/Breeder Directory.

___ \$30 Annual Junior - Individual Only - Age 18 & Under - Birth Date _____. No vote; will not receive yearbook or be listed in the Member/Breeder Directory.

*Family/Firm membership please list individuals names, name of designated voter & dates of birth for children under 18.

*New members receive a literature packet: Member-breeder list, Welsh Pony Leaflet; Welsh Cob Brochure; Care/Feeding booklet; Fee Schedule; WPCSA Newsletter; WPCSA Rulebook & By-Laws; 3” WPCSA Window Decal.

Complete form & mail with fee to: Welsh Pony & Cob Society of America, Inc., 720 Green St., Stephens City, VA 22655

Amount Enclosed _____ or charge to my (circle one) Visa or MasterCard

Name as it appears on card _____

Card Number _____ 3-digit Security Code _____
(back of card)

Exp. Date _____ Signature _____

MEMBERSHIP

- a) Any person, firm or corporation owning or interested in Welsh ponies or cobs shall be eligible for membership.
- b) There shall be two (2) classes of membership: voting and non-voting.

Voting memberships are defined as follows:

- 1. Senior Life Membership – those persons who have reached their 18th birthday by January 1st of the current year.
- 2. Annual Membership – those persons who have reached their 18th birthday by January 1st of the current year.
- 3. Family/Firm – immediate family unit - parent/guardian and minor children (who have not reached their 18th birthday) or a corporation/firm or association. The Family/Firm unit will be entitled to only one vote.

Non-Voting Memberships shall be defined as follows:

- 4. Junior Life Membership – those persons who have not reached their 18th birthday by January 1st of the current year. Upon reaching 18, the membership will become Senior Life.
- 5. Annual Associates - those persons who have reached their 18th birthday by January 1st of the current year & who are interested in the breed but do not desire full membership privileges. No reduction of transfer & registration fees.
- 6. Junior Membership - those persons who have not reached their 18th birthday by January 1st of the current year.

Privileges WPCSA Members: Reduced registration and transfer fees (with the exception of Annual Associate members); Privilege of appearing in the Member-Breeder Directory (with the exception of Junior & Annual Associate members); Right to compete for High Score Awards; Subscription to quarterly WPCSA Welsh Review Newsletter. All new members receive a complimentary literature packet. New Life members receive a complimentary pin; new Annual, Family/Firm & Annual Assoc. members receive a complimentary three-inch decal; new Junior members receive a complimentary poster.

Note: Your dues or contribution to the association are not deductible as charitable contributions. Please consult with your tax advisor to determine whether they may be deducted under other provisions of the law (such as the provisions relating to the deductibility of business expenses).

Every entry at a WPCSA sanctioned show shall constitute an agreement and affirmation that all participants (which include without limitation the owner, lessee, trainer, manager, agent, coach, driver, rider handler and the horse) for themselves, their principals, representatives, employees and agents: 1) shall be subject to the rules of the WPCSA, The Oklahoma-Kansas Welsh Pony Society (OKWPS), and the Tulsa Area Pony Show (TAPS); 2) represent that every horse, rider, driver and handler is eligible as entered; 3) agree to be bound by the rules of the WPCSA, OKWPS and TAPS, and accept as final any decision of the WPCSA, OKWPS and TAPS on any questions arising under said rules and agree to hold the WPCSA, OKWPS and TAPS, their Officials, Directors and Employees harmless for any action taken; 4) agree that they participate voluntarily in the competition fully aware that equine sports and the competition involve inherent dangerous risks and by participating they expressly assume all risks of injury or loss and agree to indemnify and hold the WPCSA, OKWPS and TAPS, and their Officials, Directors, Employees, and Agents harmless from all claims including injury or loss during or in connection with the competition whether or not such injury or loss resulted, directly or indirectly, from negligent acts or omissions of said Officials, Directors, Employees, and Agents of the WPCSA, OKWPS and TAPS.

Each person signing this form acknowledges that he/she has read the above statement and agrees to the applicable terms, conditions, waivers and consent as set forth herein. Each person agrees that the information is accurate to best of his/her knowledge.

X _____
Signature of Exhibitor or Agent **and Signature of Parent or Guardian giving Permission for a Junior Exhibitor to Show**

Name of Junior Exhibitor _____ Date of Birth _____

Name of Junior Exhibitor _____ Date of Birth _____

Name of Junior Exhibitor _____ Date of Birth _____

The Members of the OKWPS wish each competitor and visitor the best of luck at our 2017 show!!!



Oklahoma-Kansas Welsh Pony Society ♦ Tulsa Area Pony Show

May 27-29, 2017 ♦ Claremore, OK Expo Center

Only one animal on each entry form. Entry form **MUST BE SIGNED** for entries to be accepted.

WPCSA Customer ID# _____

NAME OF OWNER _____

ADDRESS _____

PHONE _____

E-MAIL _____

Please send with entries:

- Copy of registration papers (front and back)
 - Copy of current measurement cards
- all Welsh and Half-Welsh in performance and all Welsh and Half-Welsh Breeding animals six years of age and older showing in WPCSA pointed classes **MUST** be measured or present valid (current) USEF or WPCSA measurement card.

A negative Coggins Test Certificate (current within one year of the show) must be presented to the Show Secretary upon arrival. No copies accepted.

NAME OF ANIMAL	COLOR	SEX	HEIGHT	AGE	WPCSA REG. #

SIRE NAME & REGISTRATION NUMBER:

DAM NAME & REGISTRATION NUMBER:

ENTRY NO. <small>(office use only)</small>	WRITE CLASS NUMBER BELOW NAME OF CORRESPONDING RIDER	RIDER'S DATE OF BIRTH														
	NAME OF RIDER > _____ WPCSA Customer ID# _____															
CLASSES >	<table border="1" style="width: 100%; border-collapse: collapse;"> <tr> <td style="width: 10%; height: 20px;"></td> <td style="width: 10%;"></td> <td style="width: 10%;"></td> <td style="width: 10%;"></td> <td style="width: 10%;"></td> <td style="width: 10%;"></td> <td style="width: 10%;"></td> <td style="width: 10%;"></td> <td style="width: 10%;"></td> <td style="width: 10%;"></td> <td style="width: 10%;"></td> <td style="width: 10%;"></td> <td style="width: 10%;"></td> <td style="width: 10%;"></td> </tr> </table>															
	NAME OF RIDER > _____ WPCSA Customer ID# _____															
CLASSES >	<table border="1" style="width: 100%; border-collapse: collapse;"> <tr> <td style="width: 10%; height: 20px;"></td> <td style="width: 10%;"></td> <td style="width: 10%;"></td> <td style="width: 10%;"></td> <td style="width: 10%;"></td> <td style="width: 10%;"></td> <td style="width: 10%;"></td> <td style="width: 10%;"></td> <td style="width: 10%;"></td> <td style="width: 10%;"></td> <td style="width: 10%;"></td> <td style="width: 10%;"></td> <td style="width: 10%;"></td> <td style="width: 10%;"></td> </tr> </table>															
	NAME OF RIDER > _____ WPCSA Customer ID# _____															
CLASSES >	<table border="1" style="width: 100%; border-collapse: collapse;"> <tr> <td style="width: 10%; height: 20px;"></td> <td style="width: 10%;"></td> <td style="width: 10%;"></td> <td style="width: 10%;"></td> <td style="width: 10%;"></td> <td style="width: 10%;"></td> <td style="width: 10%;"></td> <td style="width: 10%;"></td> <td style="width: 10%;"></td> <td style="width: 10%;"></td> <td style="width: 10%;"></td> <td style="width: 10%;"></td> <td style="width: 10%;"></td> <td style="width: 10%;"></td> </tr> </table>															

Entry Fee - Halter: \$12.50 per class (\$25.00 for both judges)	x _____	classes	= \$ _____
Entry Fee - Performance: \$15.00 per class	x _____	classes	= \$ _____
Weekend Stall Fee: \$50.00 per stall	x _____	stalls	= \$ _____
Single Day Stall Fee: \$25.00 per stall	x _____	stalls	= \$ _____
Tack Stall: \$50.00 per stall	x _____	stalls	= \$ _____
Measurement Fee: \$5.00 per head non-member of WPCSA	x _____	head	= \$ _____
WPCSA Recording Fee: \$5.00 per pony per judge (\$10 for the weekend/pony)	x _____	head	= \$ _____
Jump Fee: \$15.00 per pony	x _____	head	= \$ _____
Office Fee: \$15.00 per owner	x _____	owner	= \$ _____
make checks payable to: OKWPS			
	TOTAL ENCLOSED		\$ _____

Mail entries to:
Denise Dougherty
2030 Lakeview Road
Crescent, OK 73028

Stall with: _____

Arrival: Date _____ Time _____